

Radiador de óleo resfriado a ar

Remoção - Radiador de óleo resfriado a ar

1. Referência de drenagem do sistema de óleo *em breve.*

2. Abra os painéis da grade frontal.

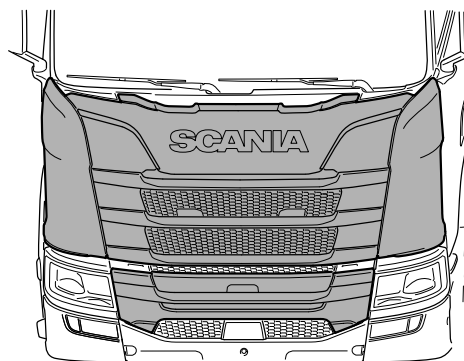

3. Instale os faróis principais,

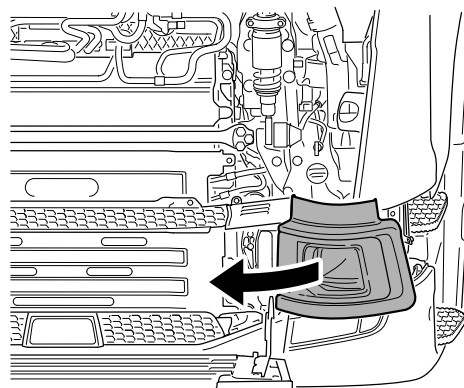

4. Remova os cantos do para-choque dos dois lados.

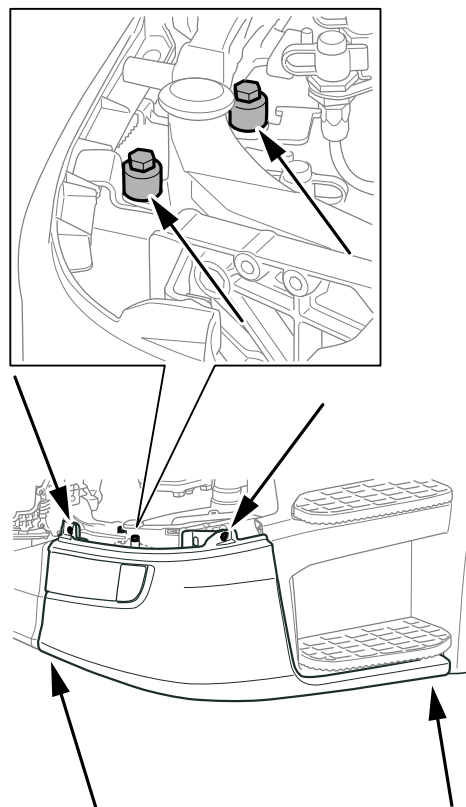

5. Remova a tampa do sensor de distância.

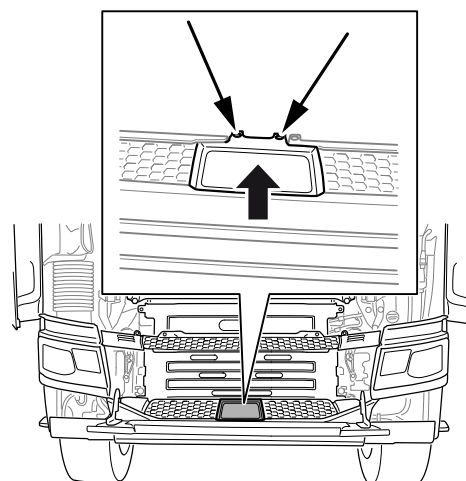

6. Remova a tampa do para-choque.

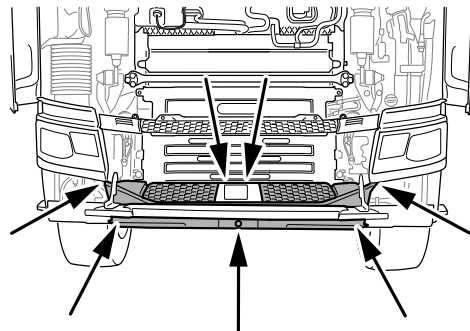

7. Solte a conexão ao sensor de distância.

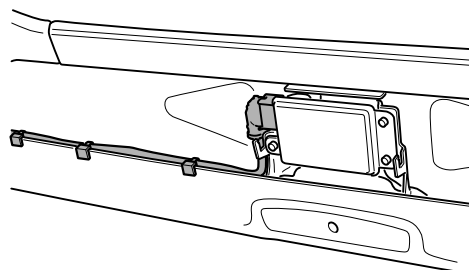

8. Remova o conjunto e o suporte do sensor de distância, se instalados, da proteção inferior ou do para-choque.

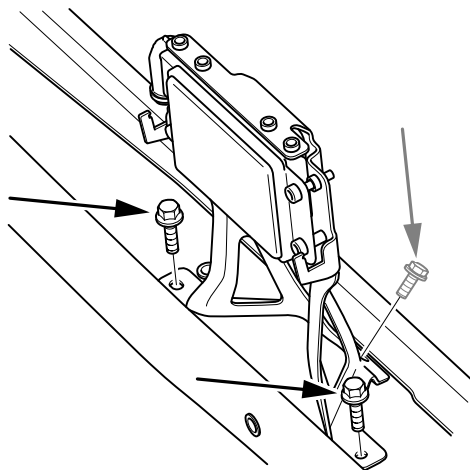

9. Remova a parte fixa da dianteira.

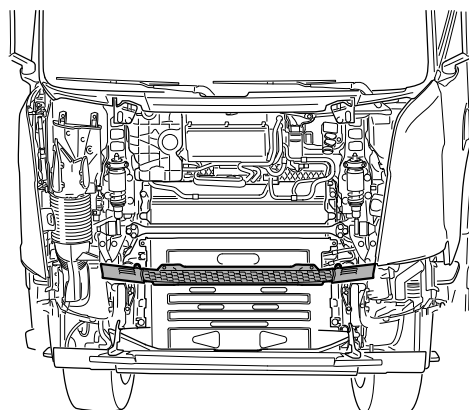

10. Remova a tela de proteção do radiador.

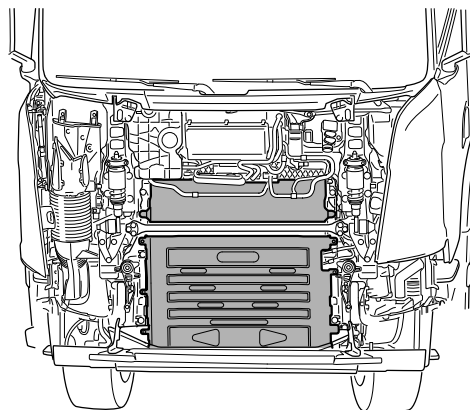

11. Afrouxe as conexões de tubo.
Remova o radiador de óleo.

