

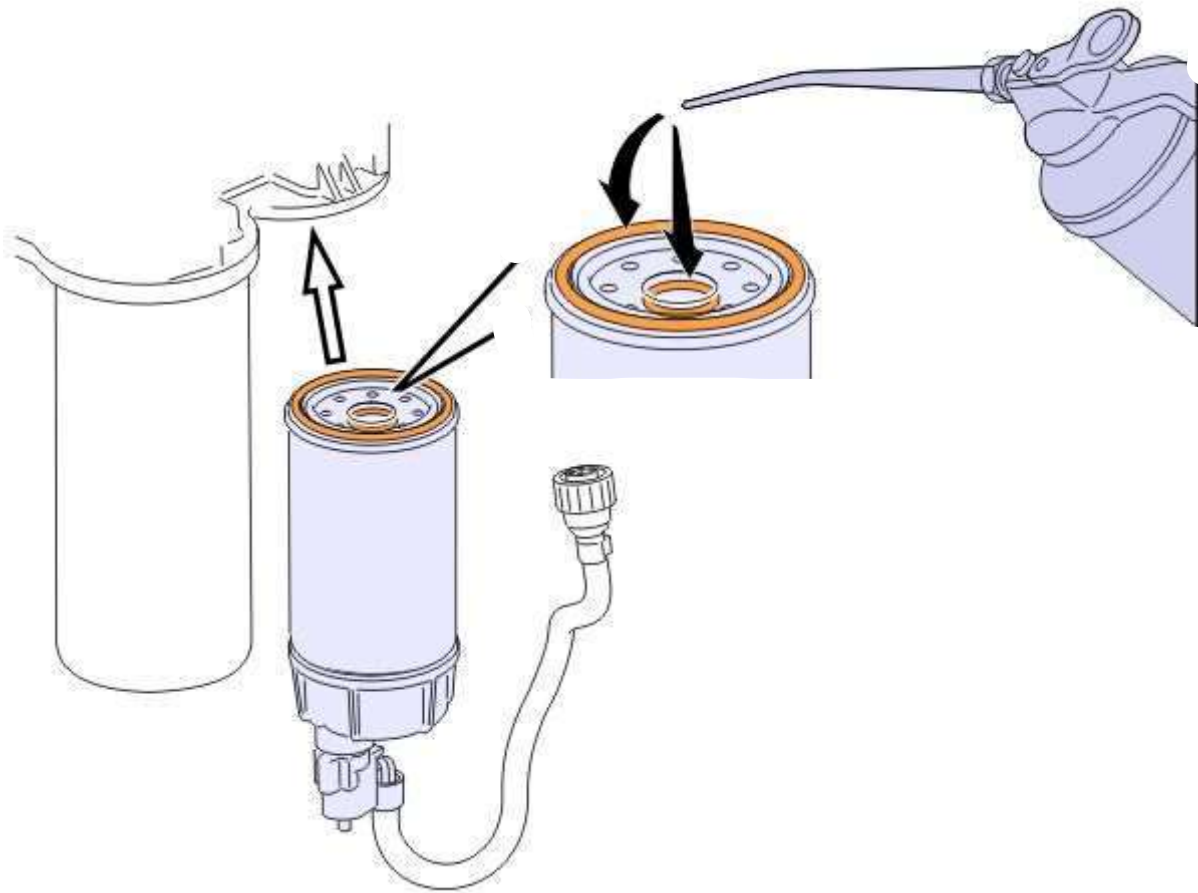

| Aplique óleo do motor.

| Instale o filtro.



Conectar o conector.

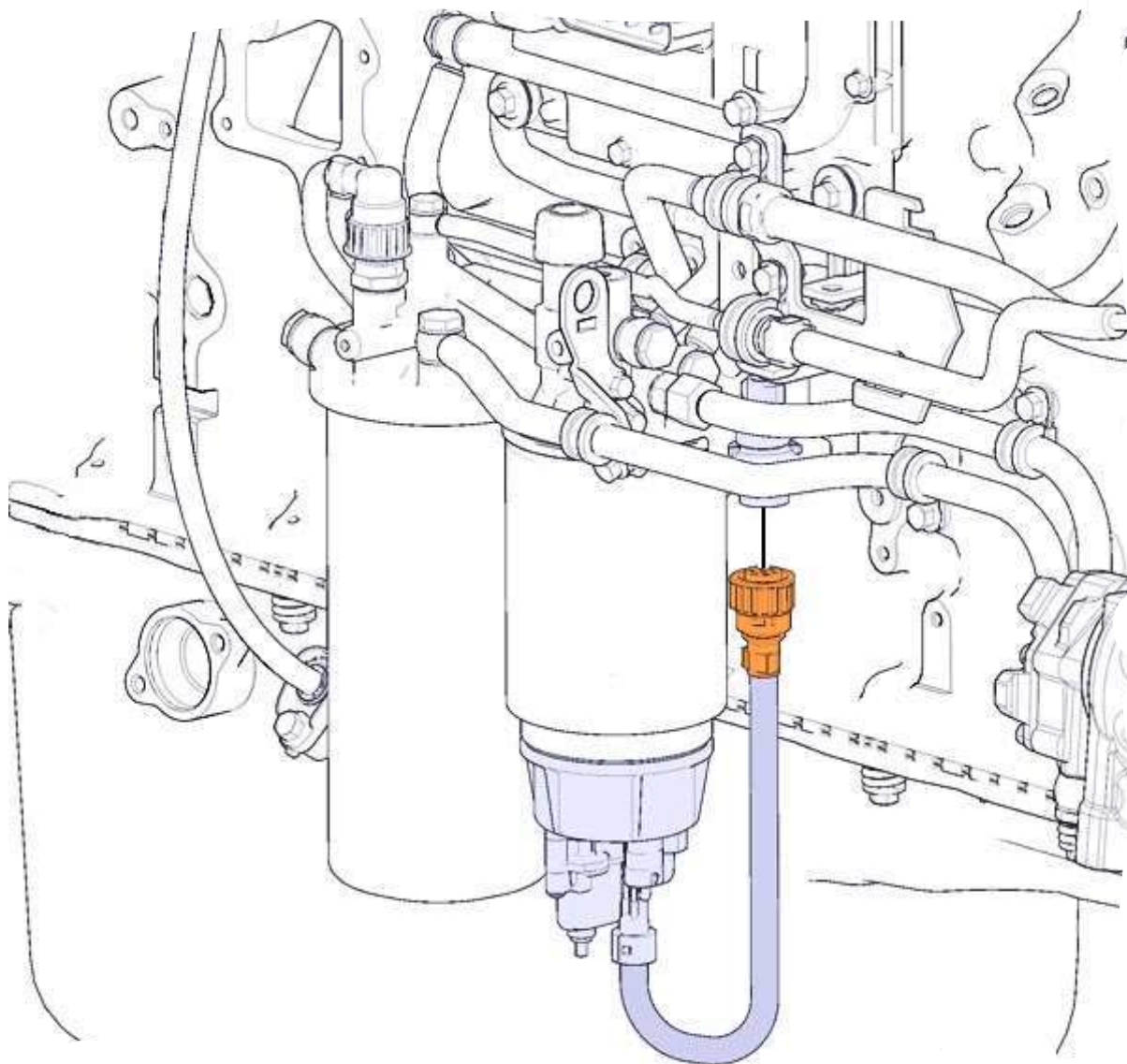

Instale a braçadeira do cabo.

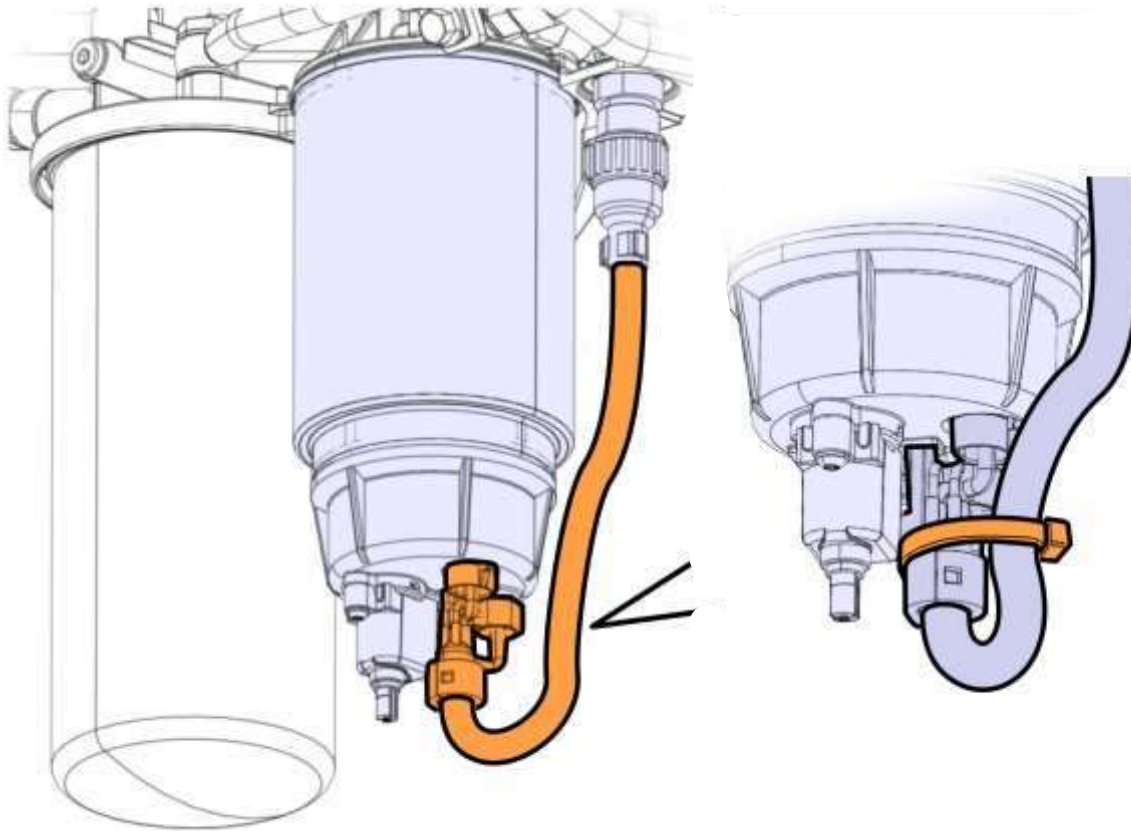

|Limpe a superfície de contato.

|Lubrificar as vedações.

Motor a diesel

|Instale o filtro de combustível.

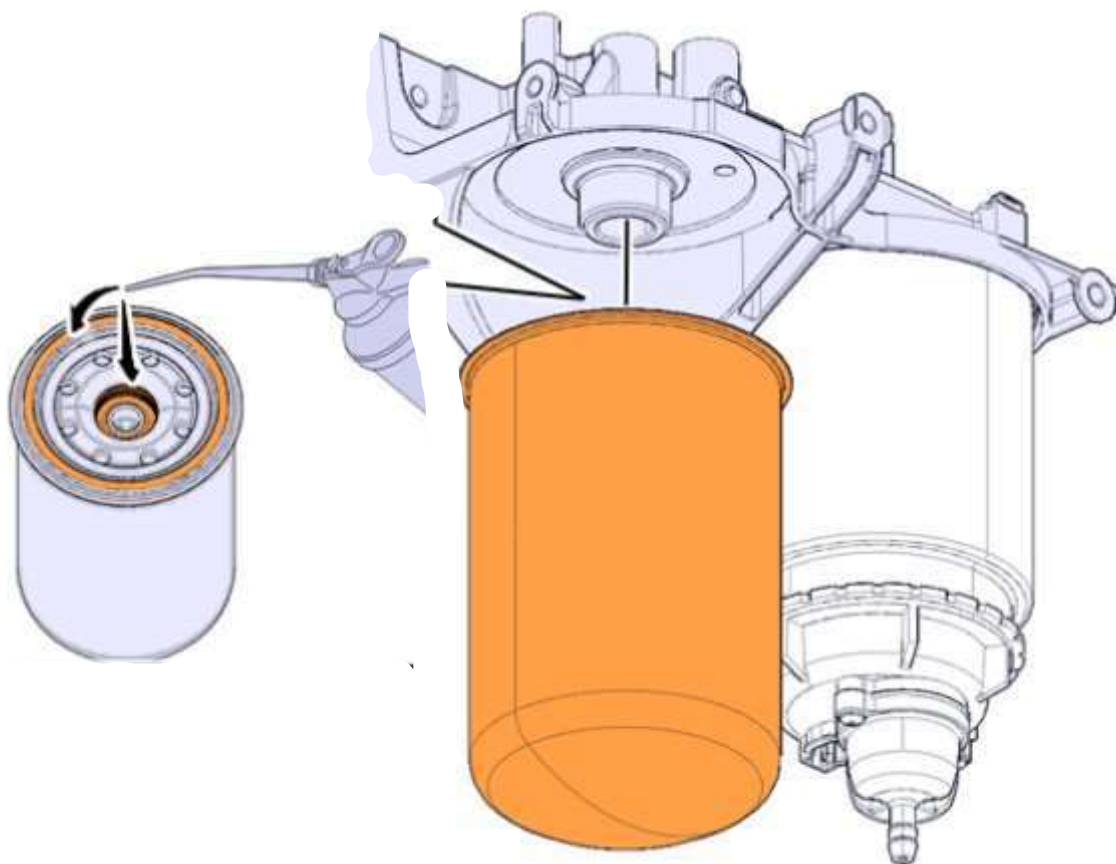

Instalar os tubos.

Instalar os parafusos, as arruelas e a porca.

Nota
Usar arruelas novas.

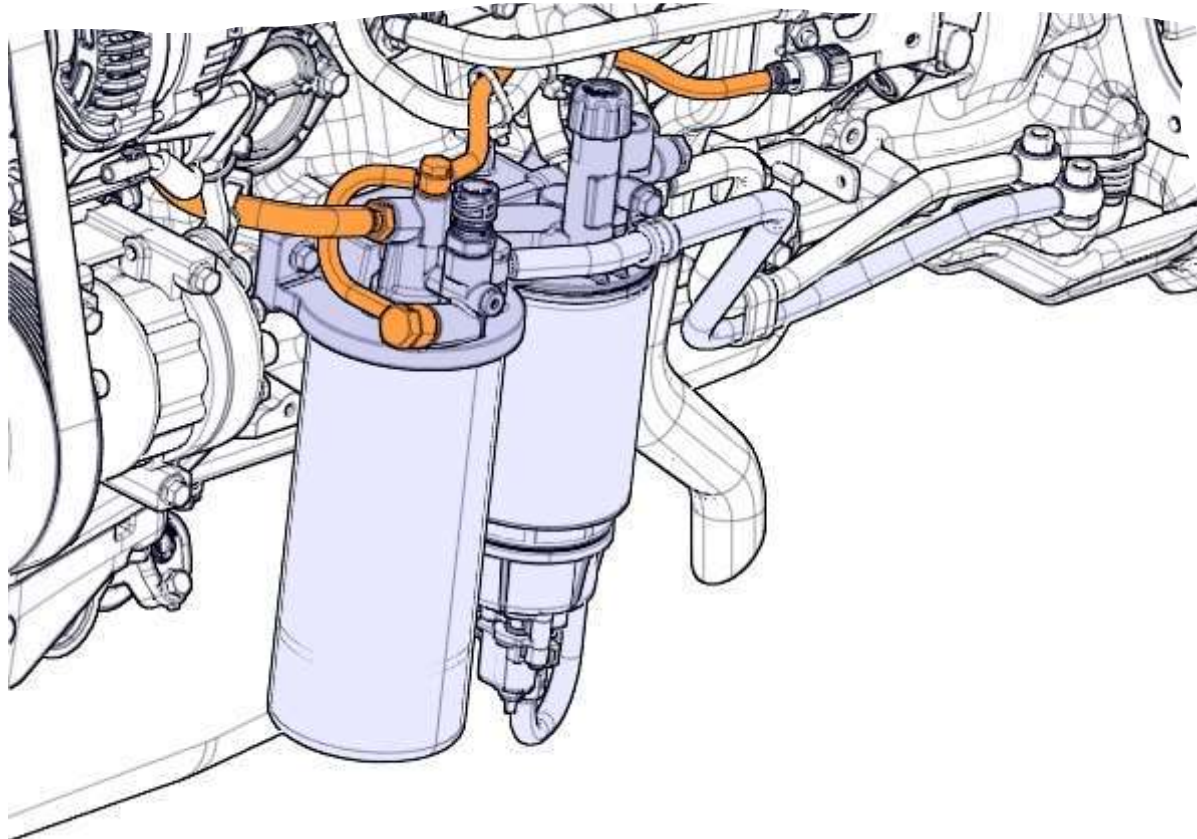

Instalar os tubos.

Instalar os parafusos, as arruelas e a porca.

Nota

Usar arruelas novas.

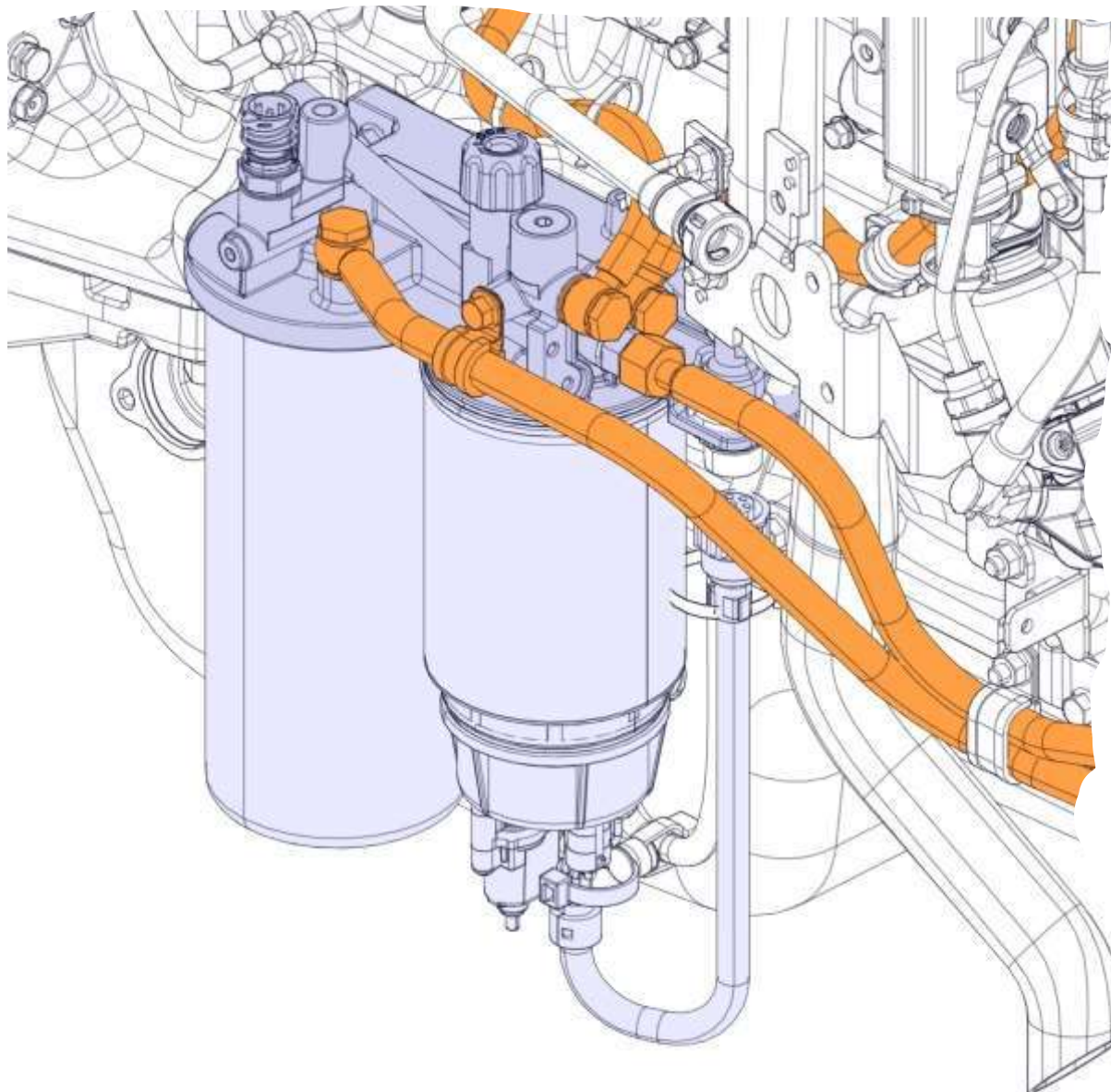

Aplicar o torque nos parafusos e na porca.
Carcaça do filtro de combustível, torque de aperto

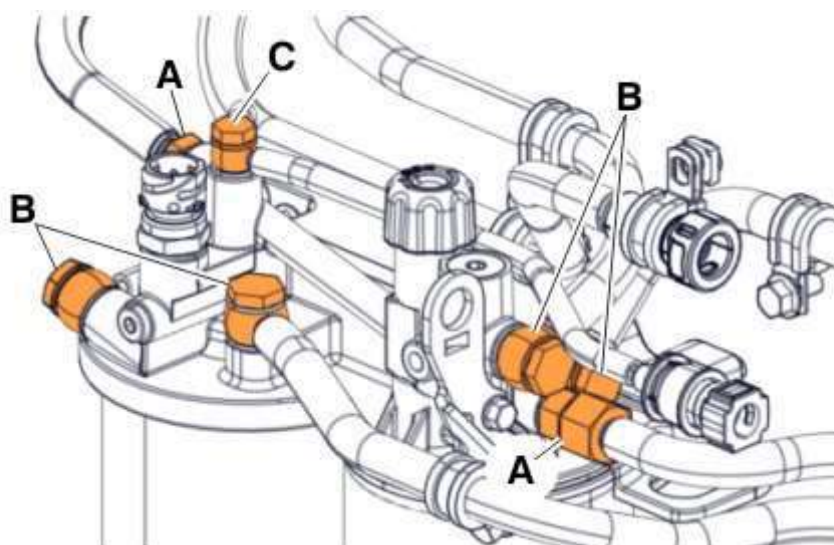

| A | Parafuso sextavado

| 30 ±4 Nm

B	Tubulação de combustível, parafuso	35 ±5 Nm
C	Tubulação de combustível, parafuso	18 ±3 Nm

| Ligar os conectores.

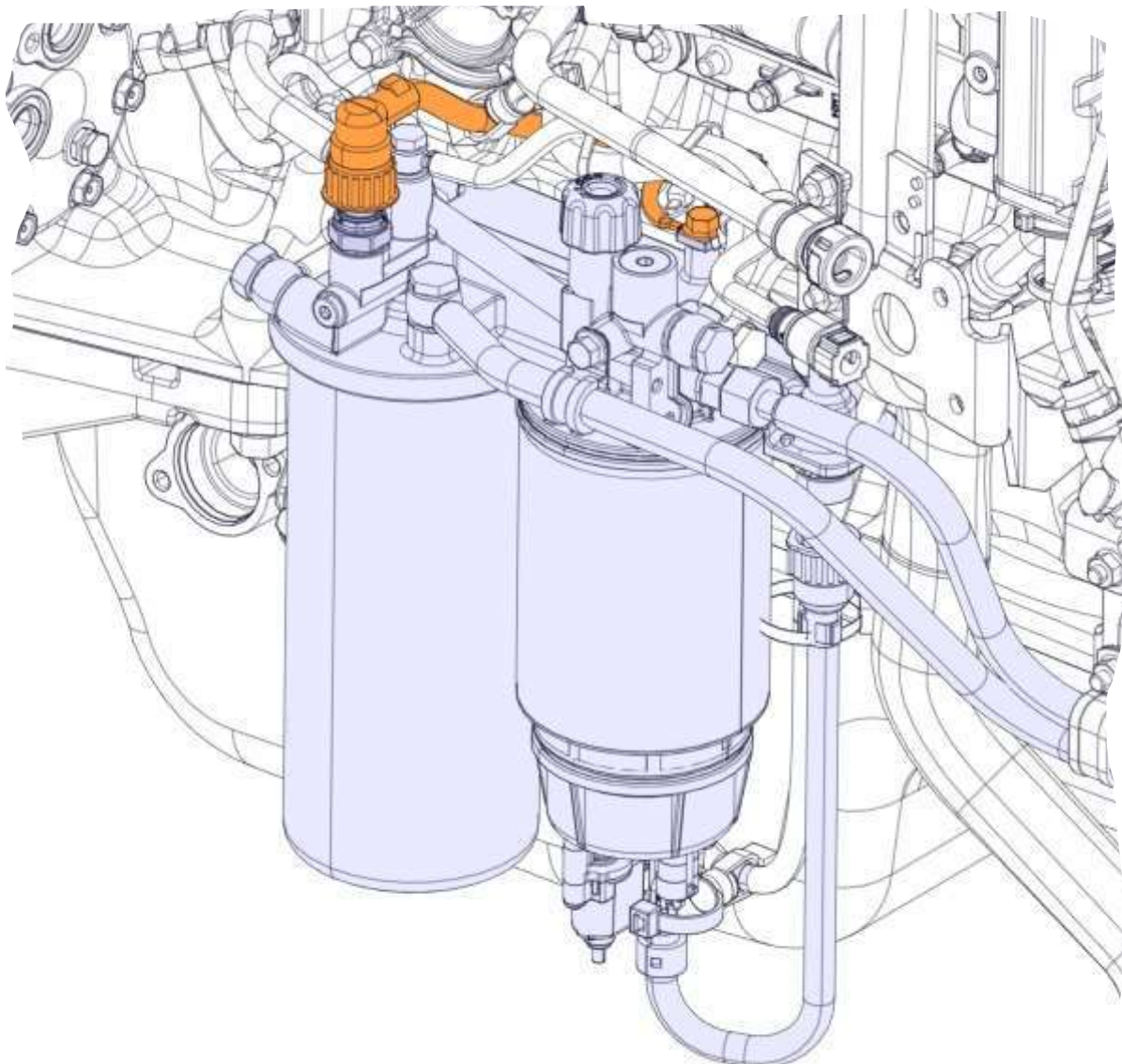

| Instalar a unidade de comando.

| Instale os parafusos.

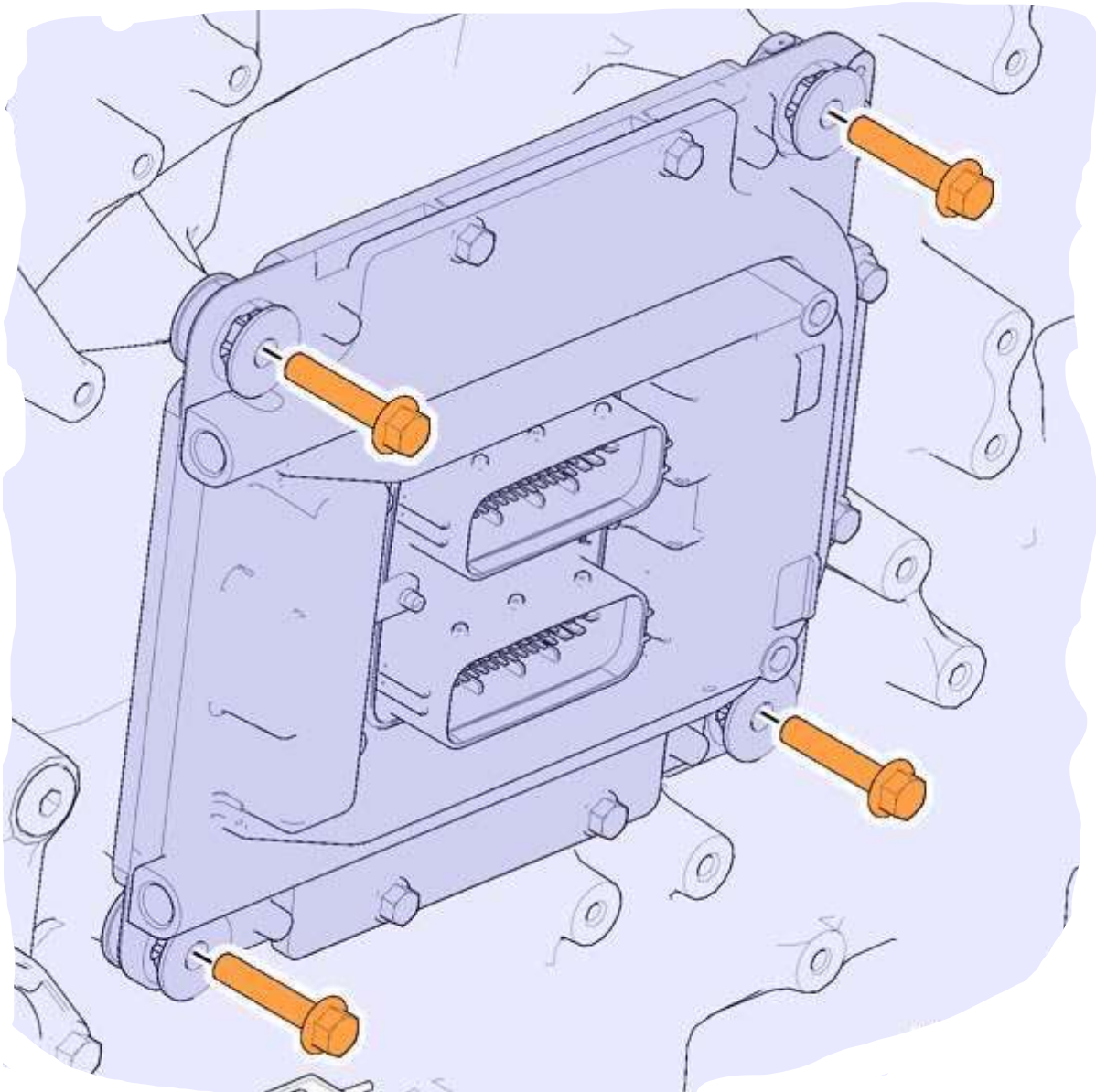

Esta etapa contém 2 alternativas.

Selecione uma das alternativas válidas abaixo.

Alternativa 1 / 2

|| Instalar os parafusos e as arruelas.

Nota

Use peças novas.

|| Aplicar o torque nos parafusos.

|| Elemento de arrefecimento, unidade de controle, niple | 35 ±5 Nm

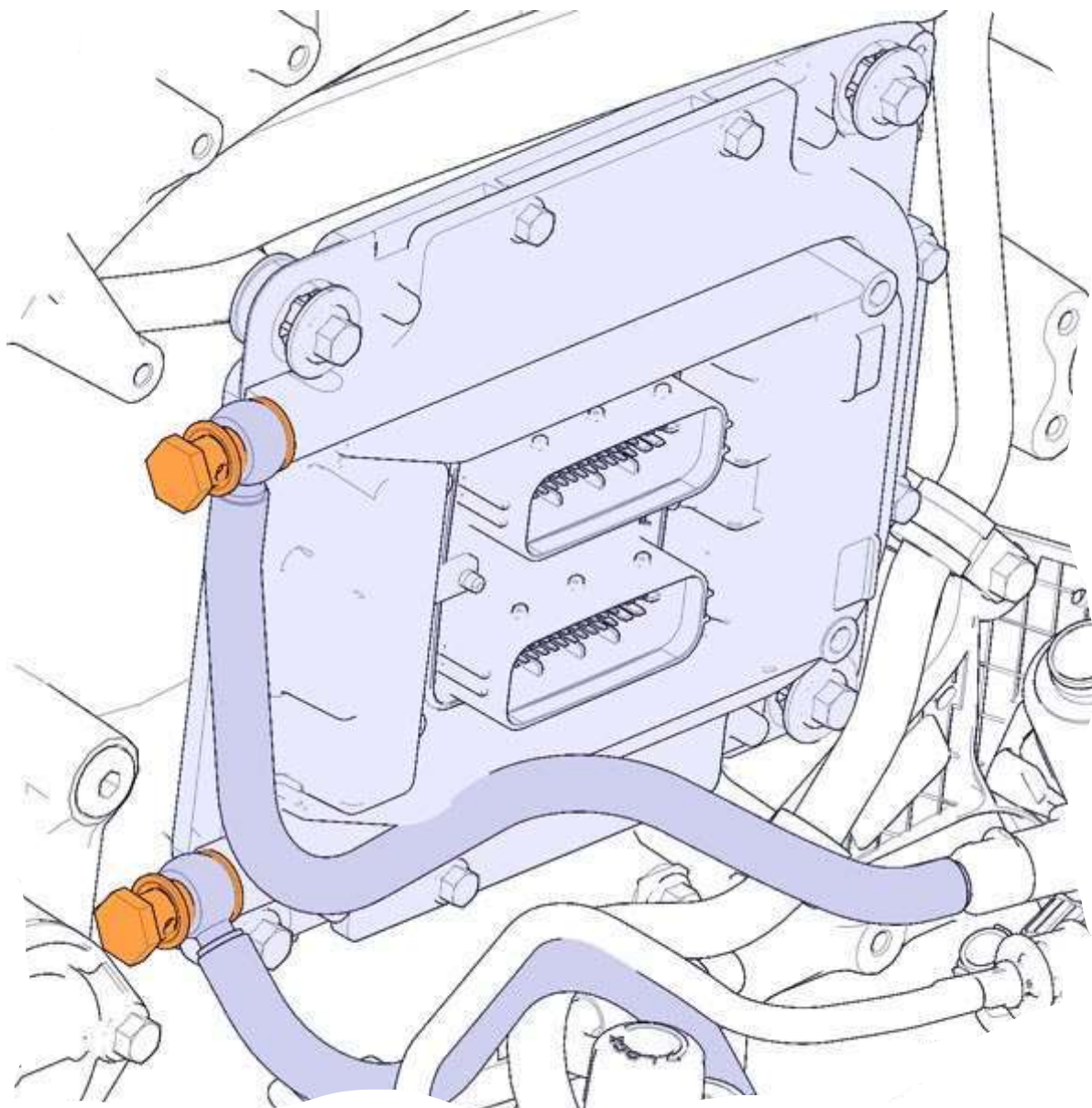

|Ligar os conectores.

|Instale os parafusos.

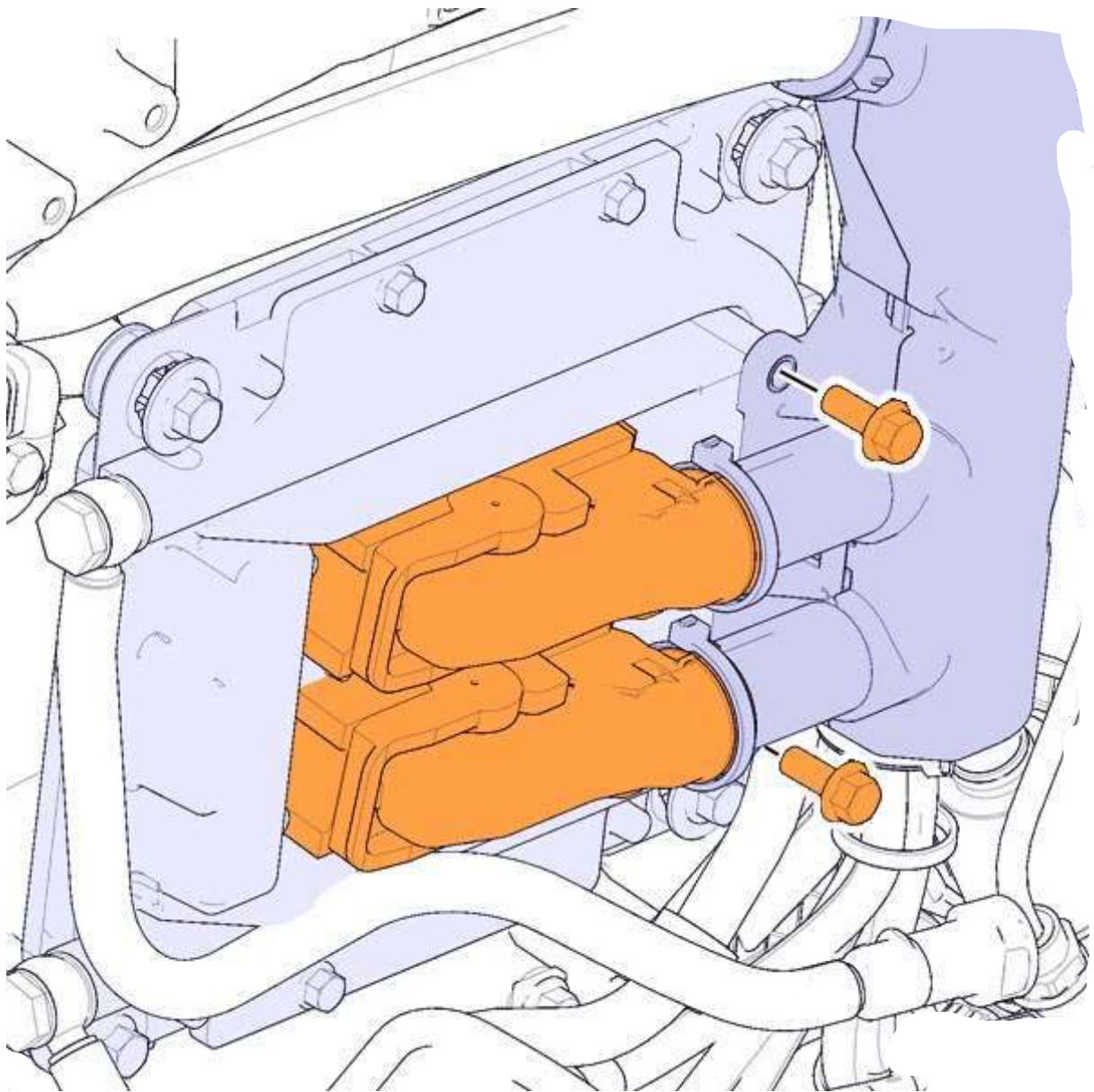

Alternativa 2 / 2

Ligar os conectores.

Instale os parafusos.

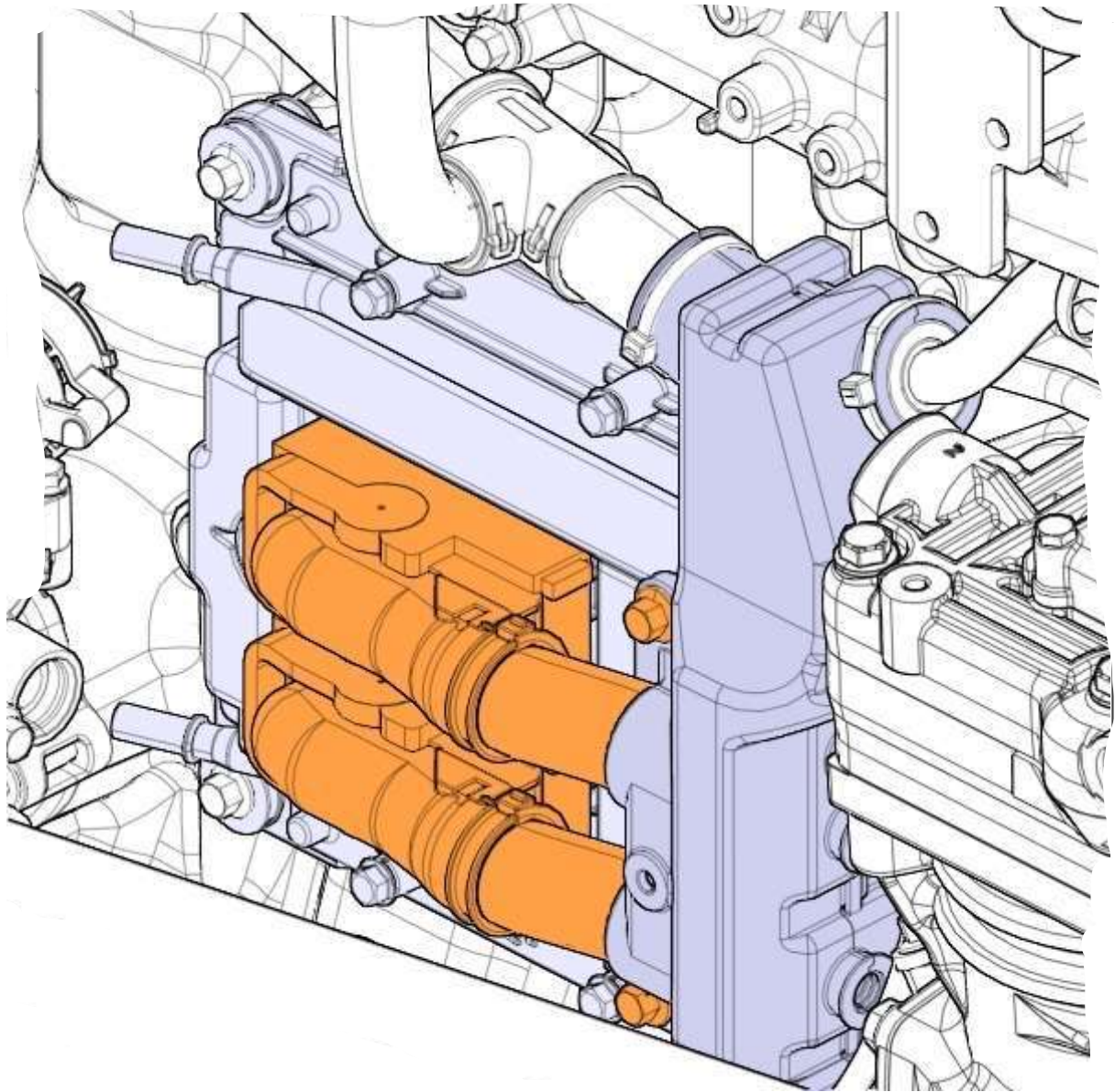

|Instalar os tubos.

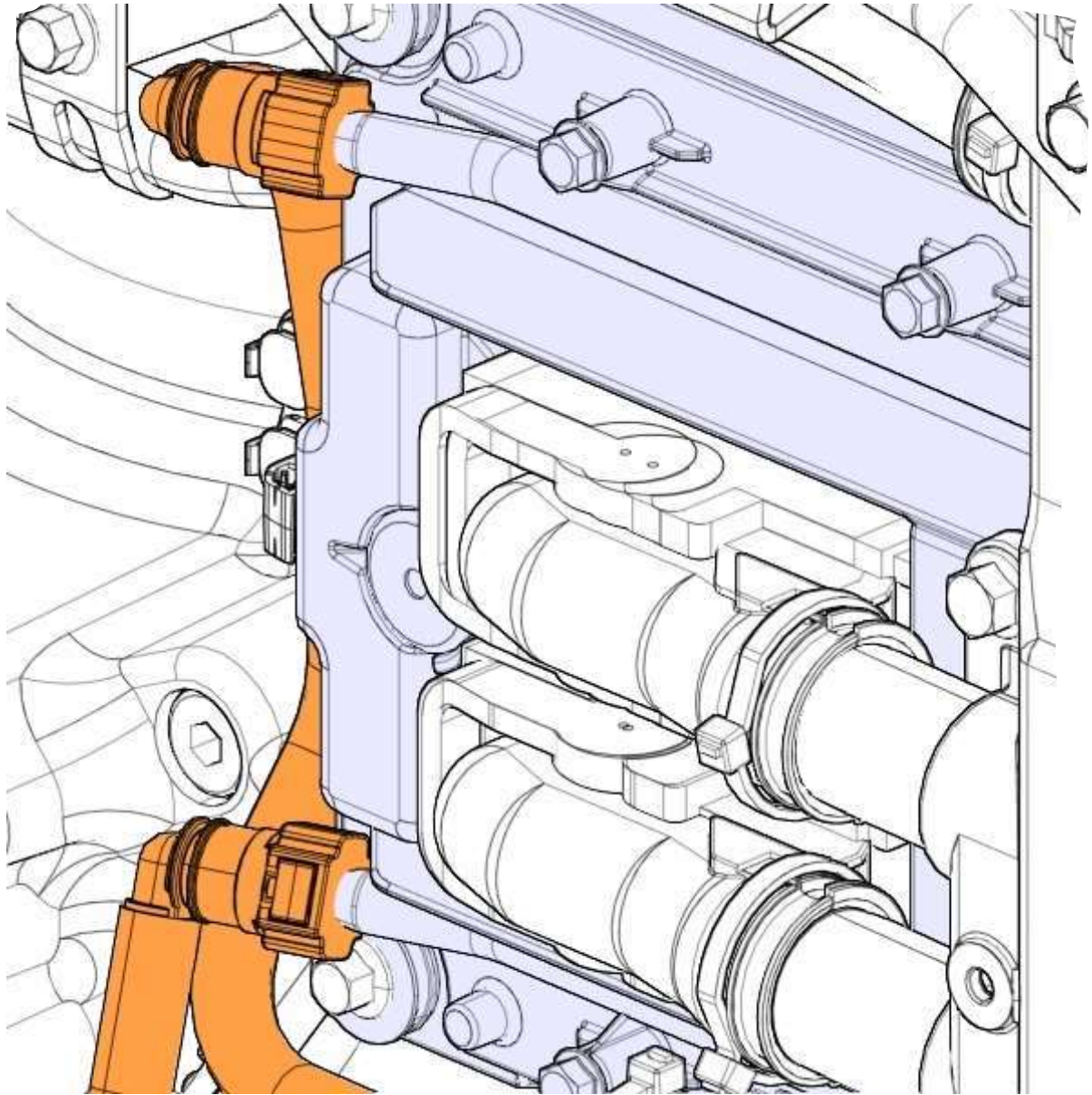

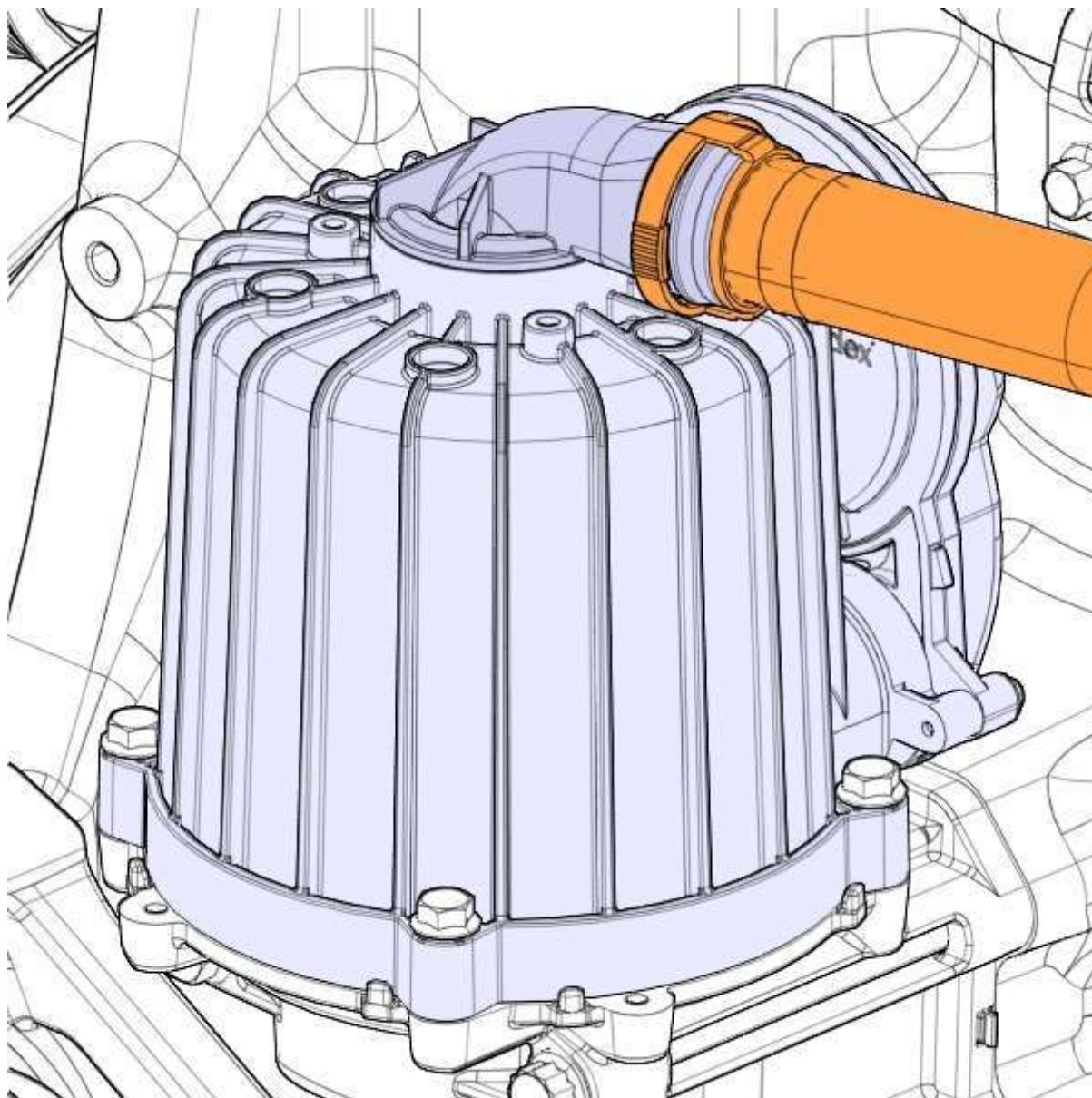

|Instale a vedação.

|Instalar o separador.

|Instalar os parafusos.

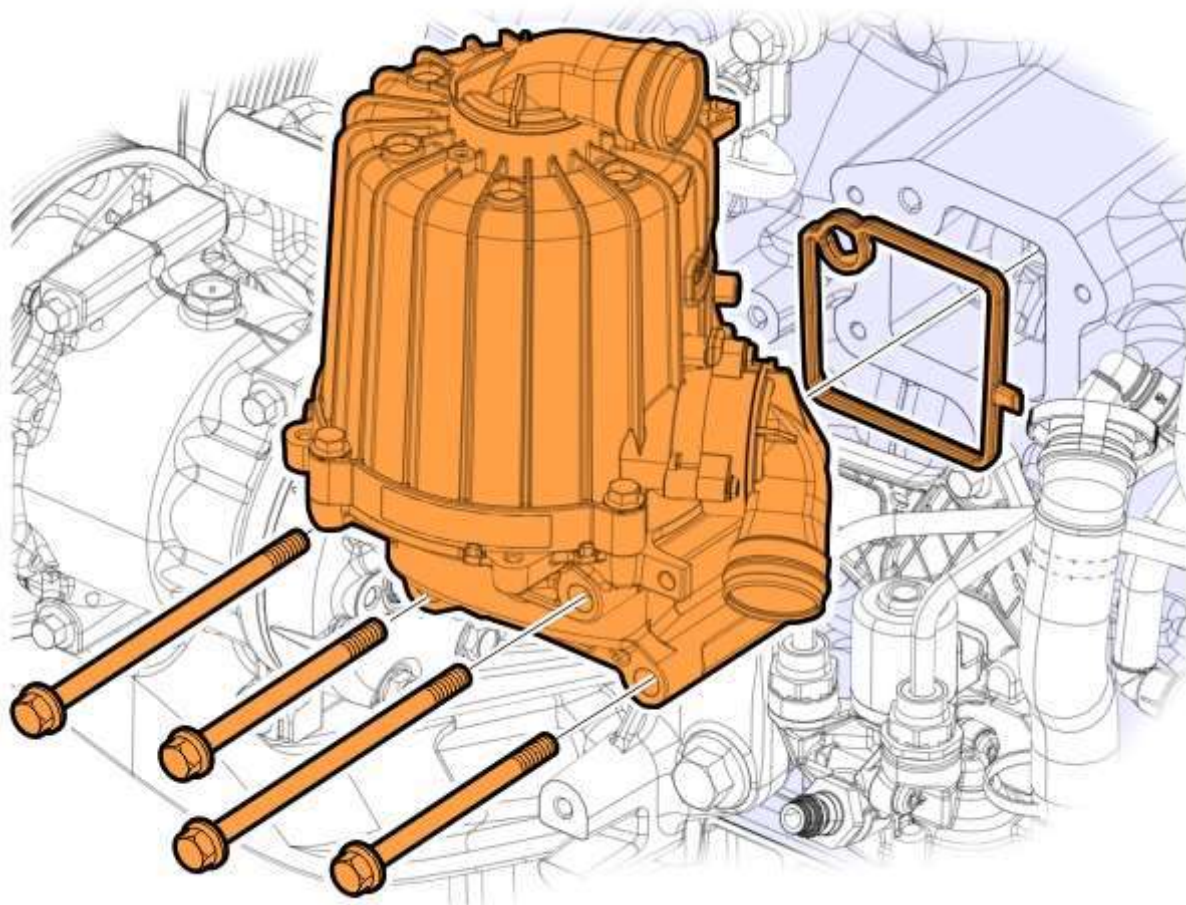

|Instalar a mangueira.

|Aperte a braçadeira.

|Instale o tubo.

