

- | | |
|------------|-----------------------|
| 318 | Instalar a mangueira. |
| 319 | Instalar o grampo. |

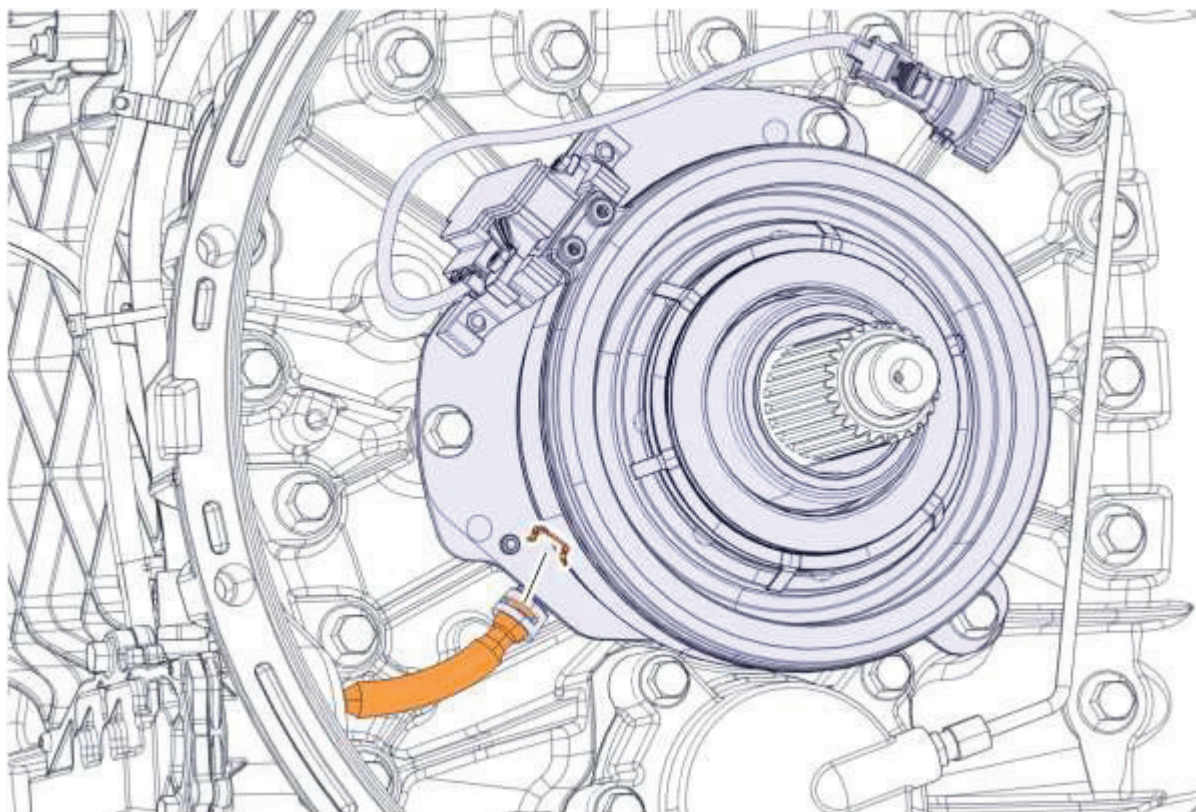

320 Execute este procedimento quando a condição abaixo for atendida.

Condições

- Se a tampa for trocada.

- ▶ Instalar os retentores.



Nota

Use peças novas.

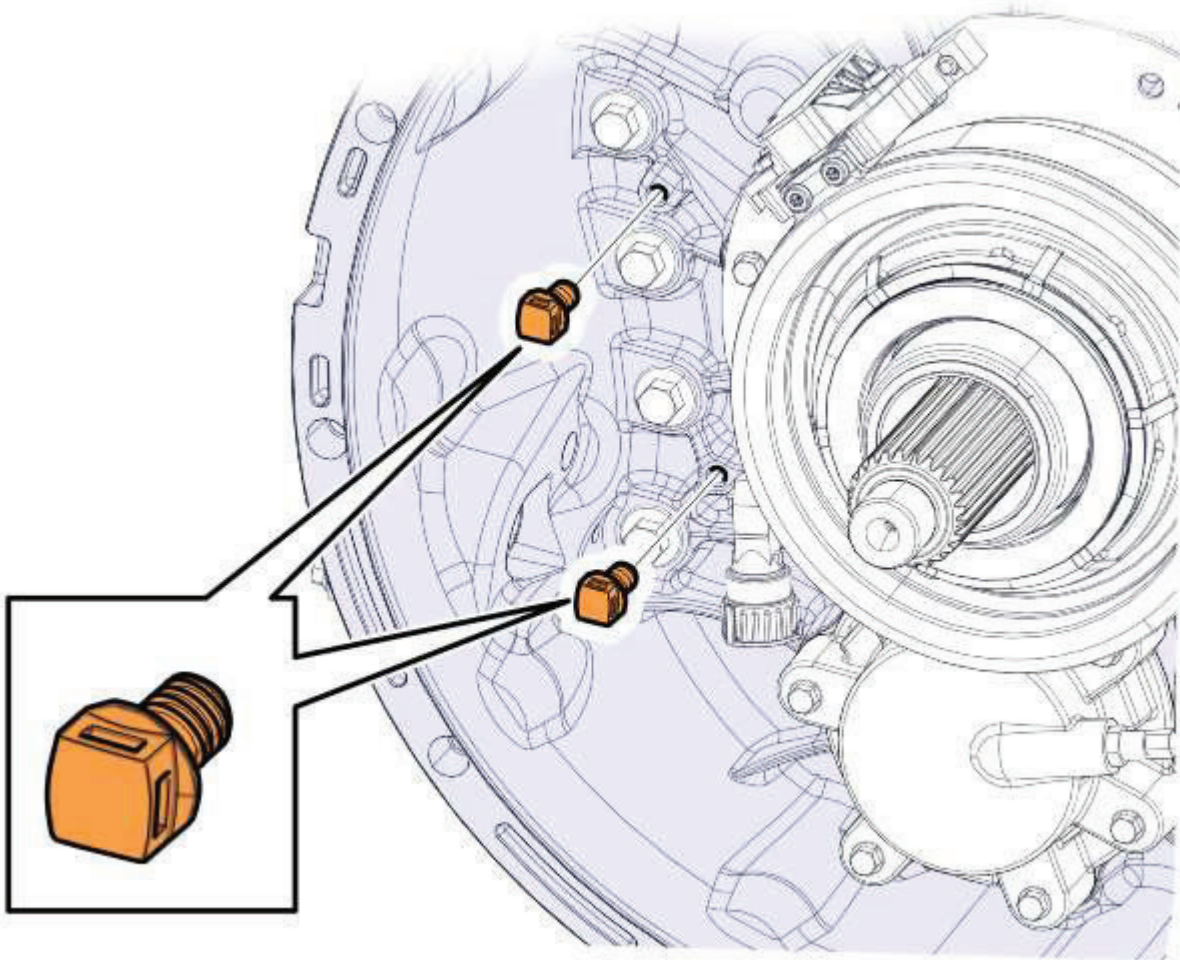

321 Conectar o conector.

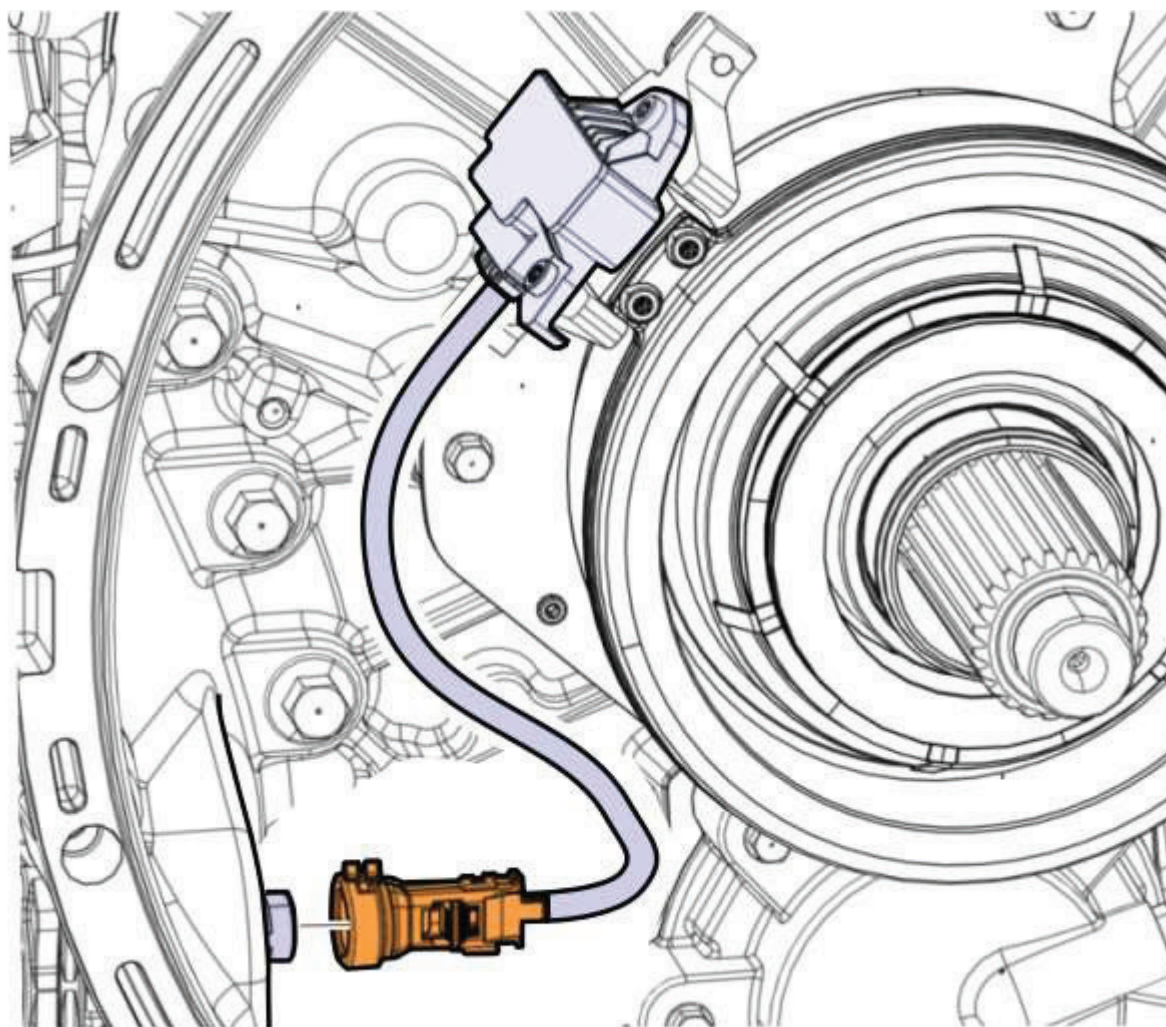

322 Instalar as braçadeiras.



Nota

Use peças novas.

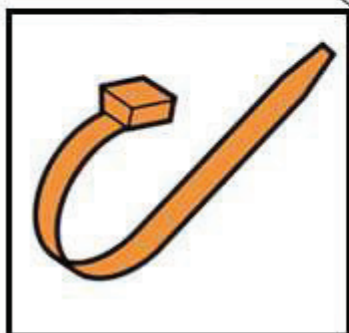
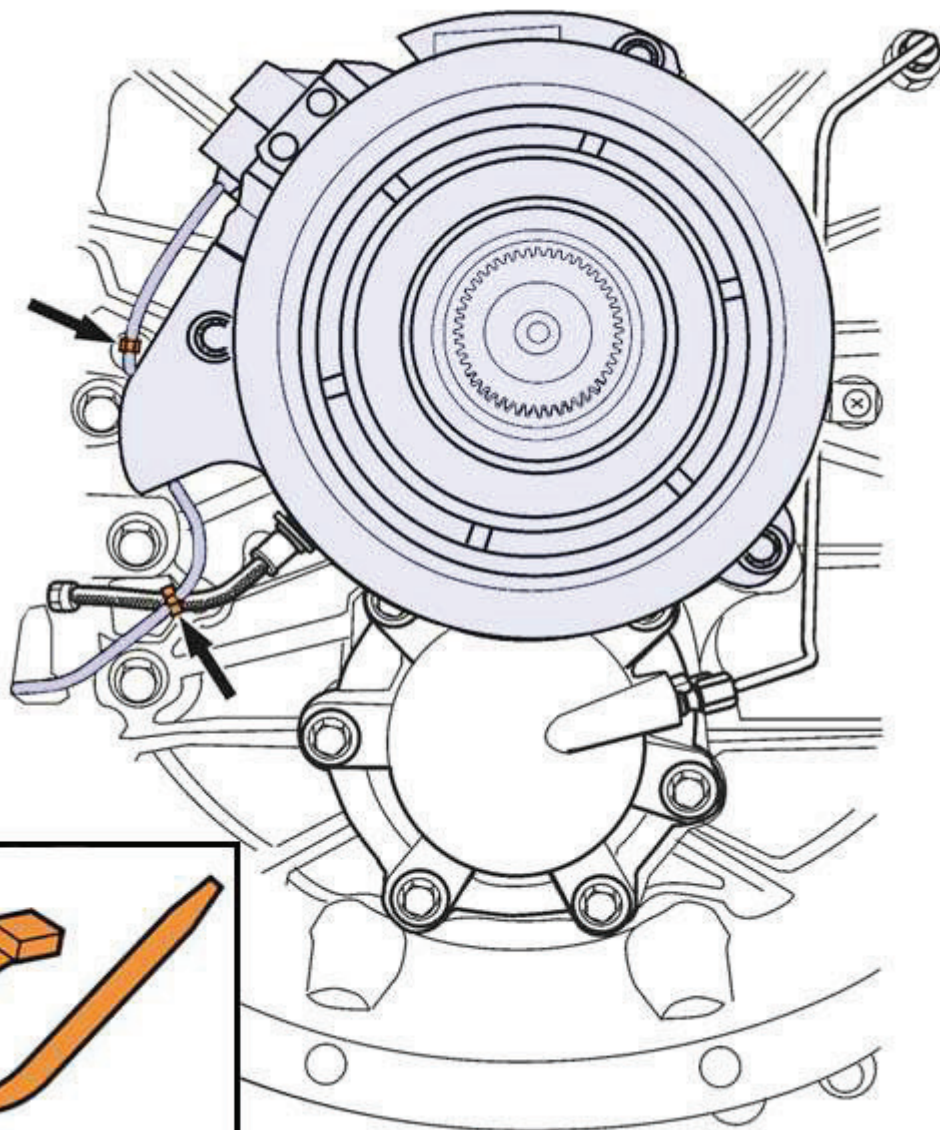

323 Limpe e verifique todas as peças.

324 Instalar os anéis em O.

i **Nota**
Usar peças novas.

325 Lubrificar os anéis-O.

Material necessário

Graxa

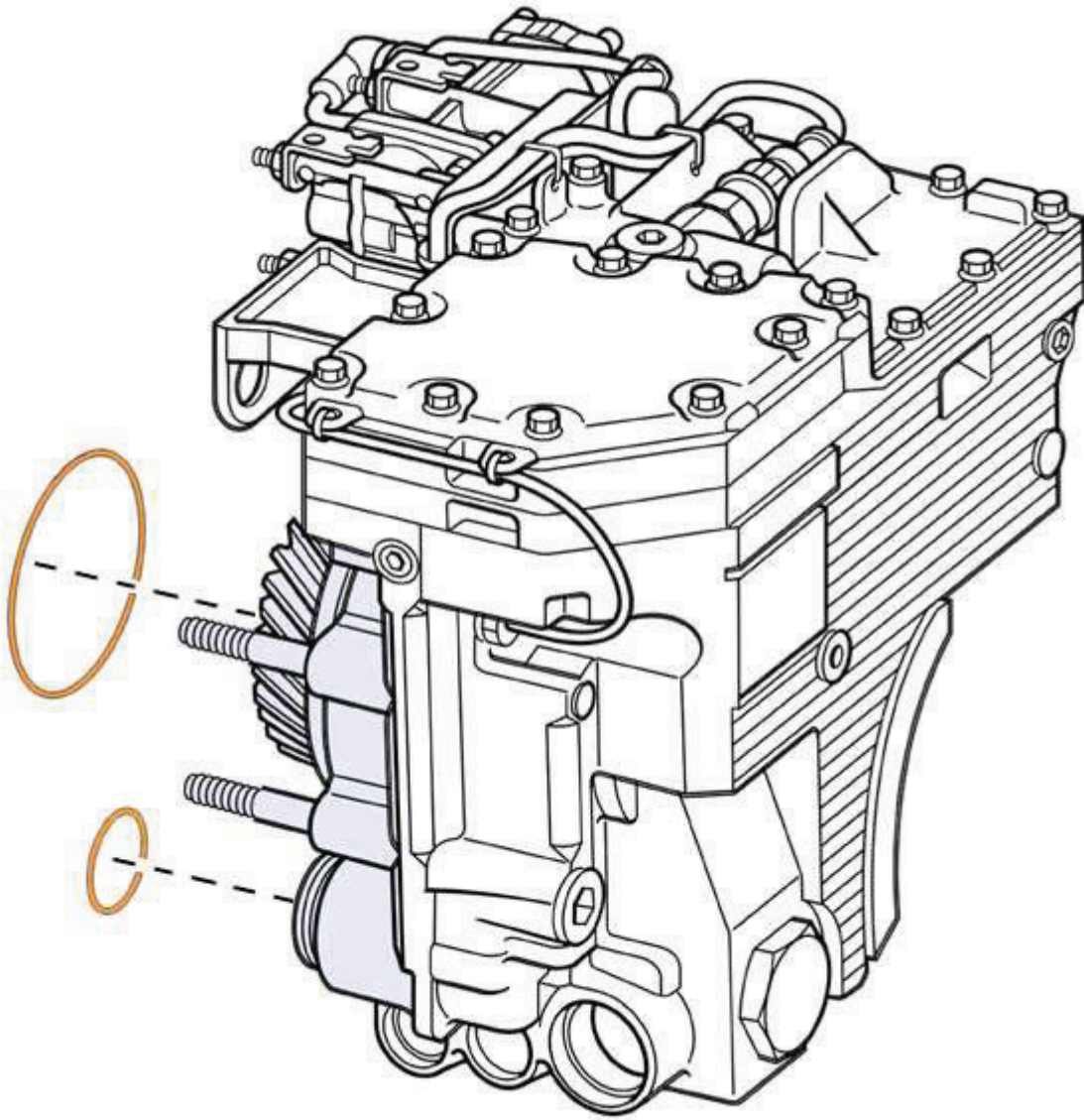

326	Girar o flange.
-----	-----------------

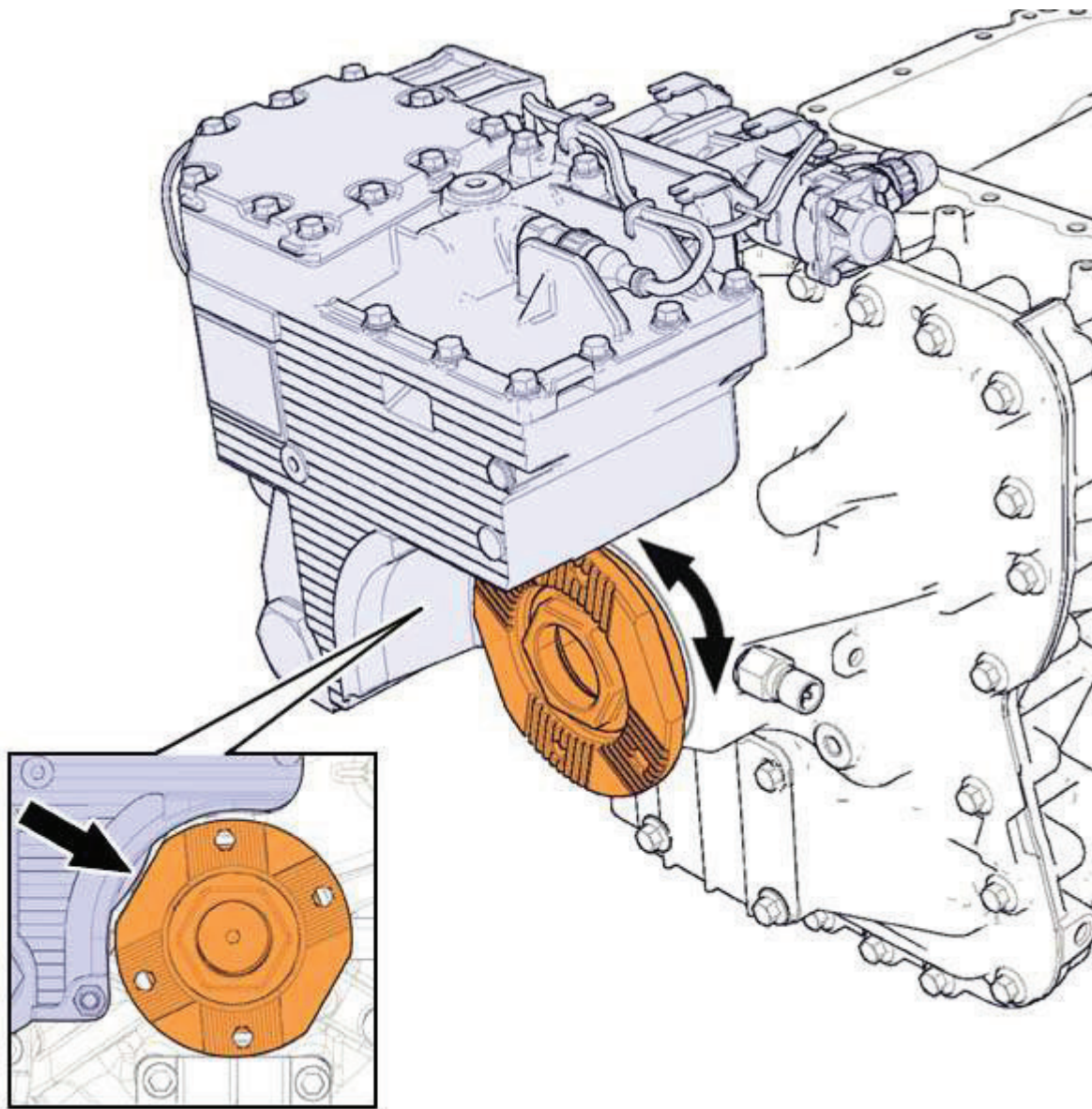

327 Ajustar o limitador de torque.



Nota

Tomar cuidado para não danificar o limitador de torque quando instalar o retardador.

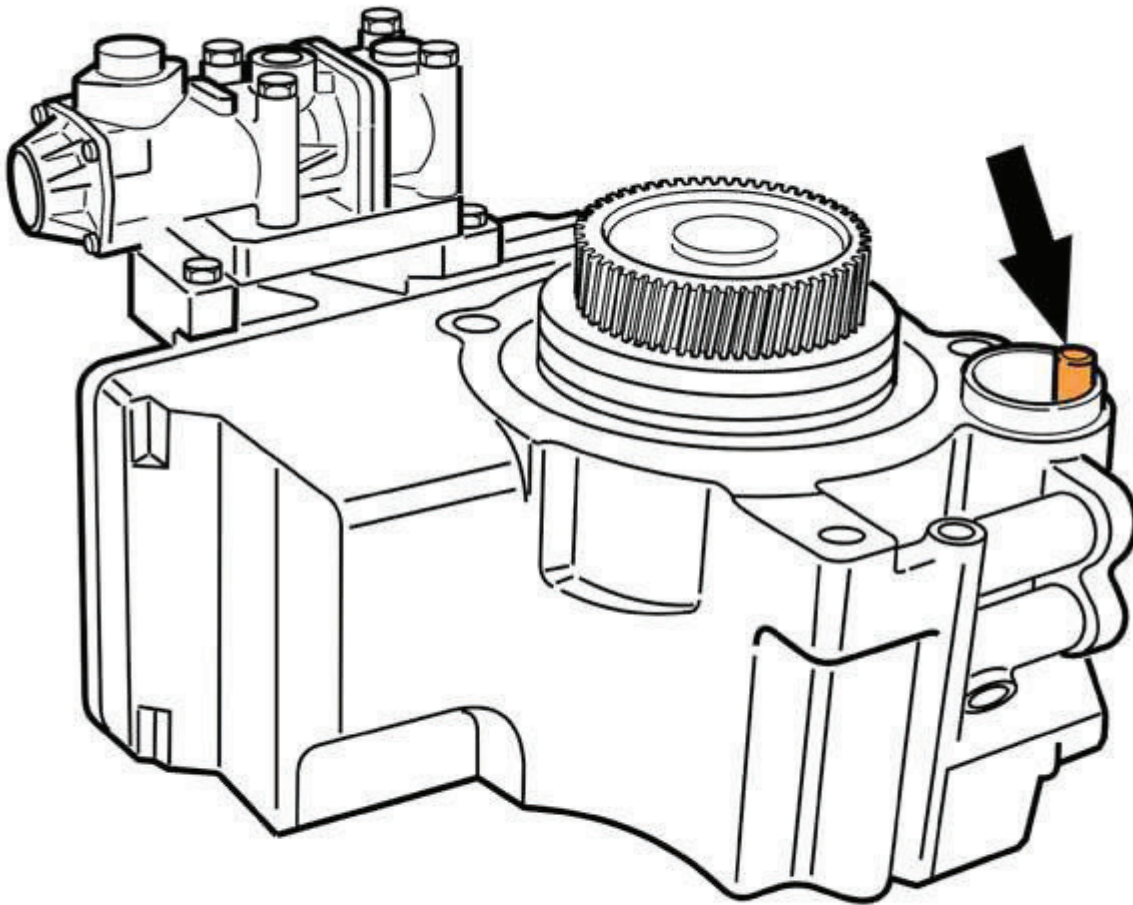

328 Instalar o retardador.



Nota

Durante a operação, certificar-se de que nenhuma peça esteja danificada.

329 Instalar as porcas (1).

330 Aplicar o torque nas porcas (1).

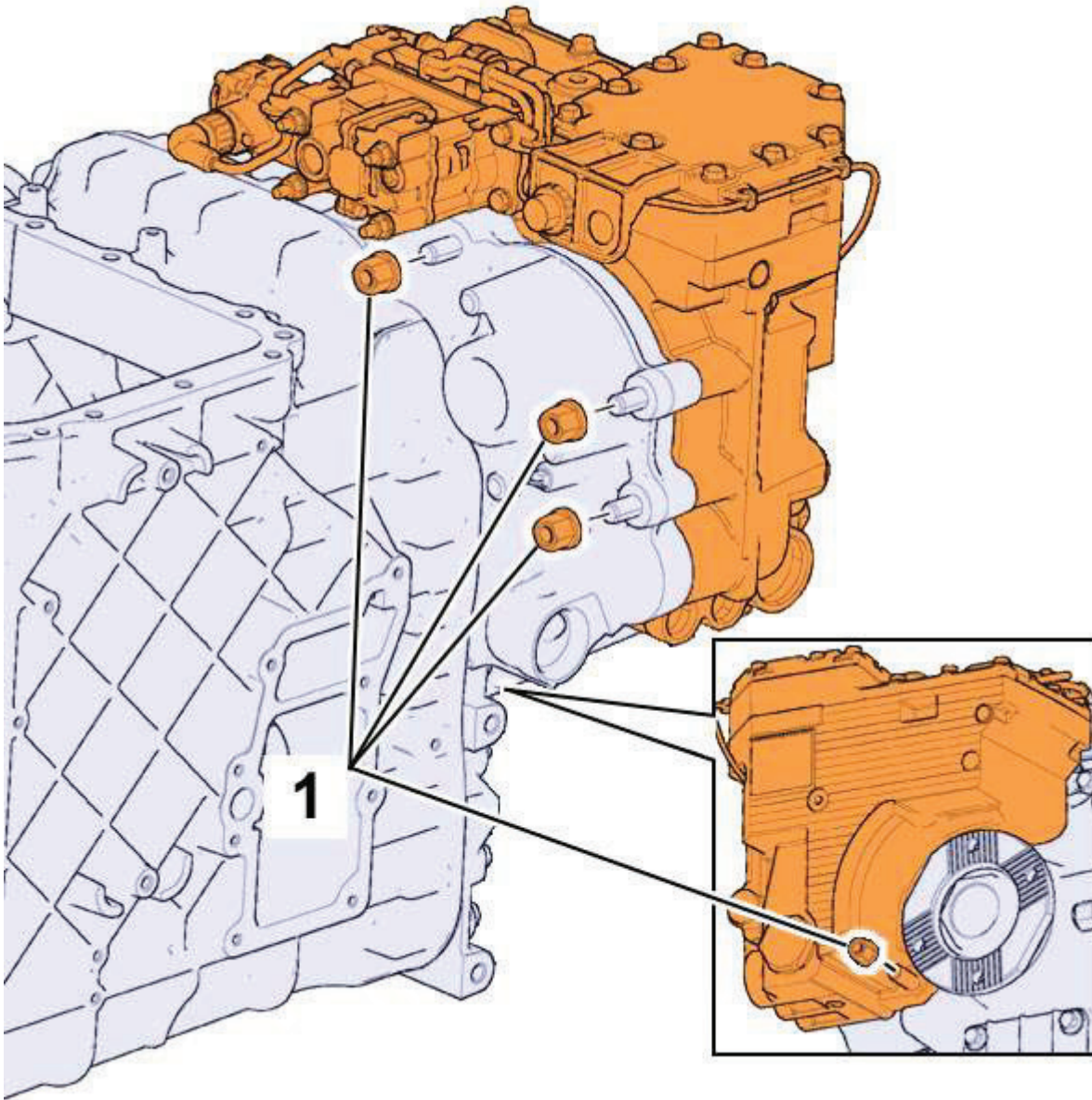

Torque		
Retardador, caixa de marcha, porca	1.	Sequência de torque: 1-4
		30 ±3 Nm
	2.	Sequência de torque: 1-4
		45 ±5°
	3.	Sequência de torque: 1-4
		45 ±5°

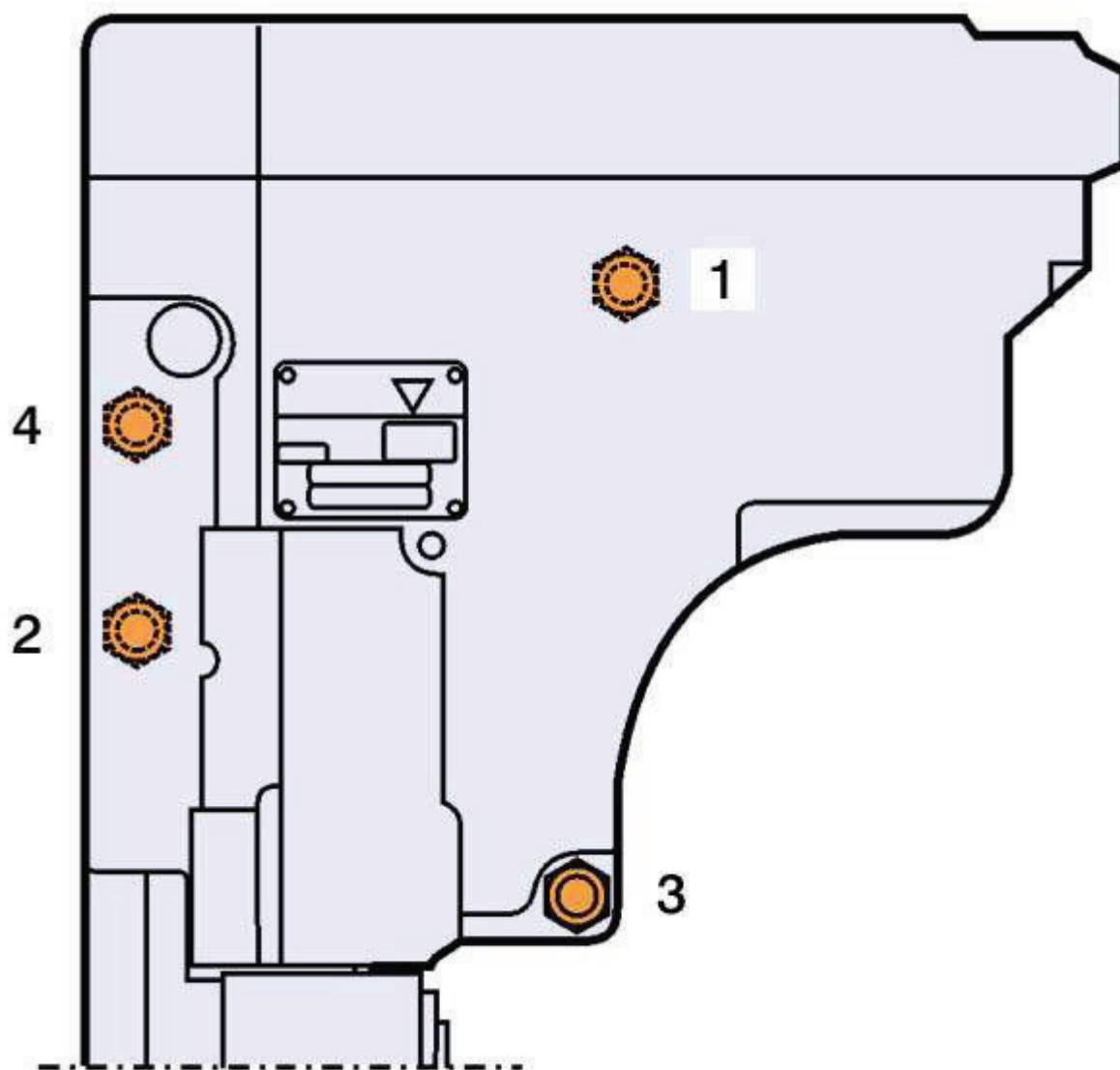

Material necessário	
MEDIDOR DE ÂNGULOS	<u> </u>

331	Remover as ferramentas.
------------	-------------------------

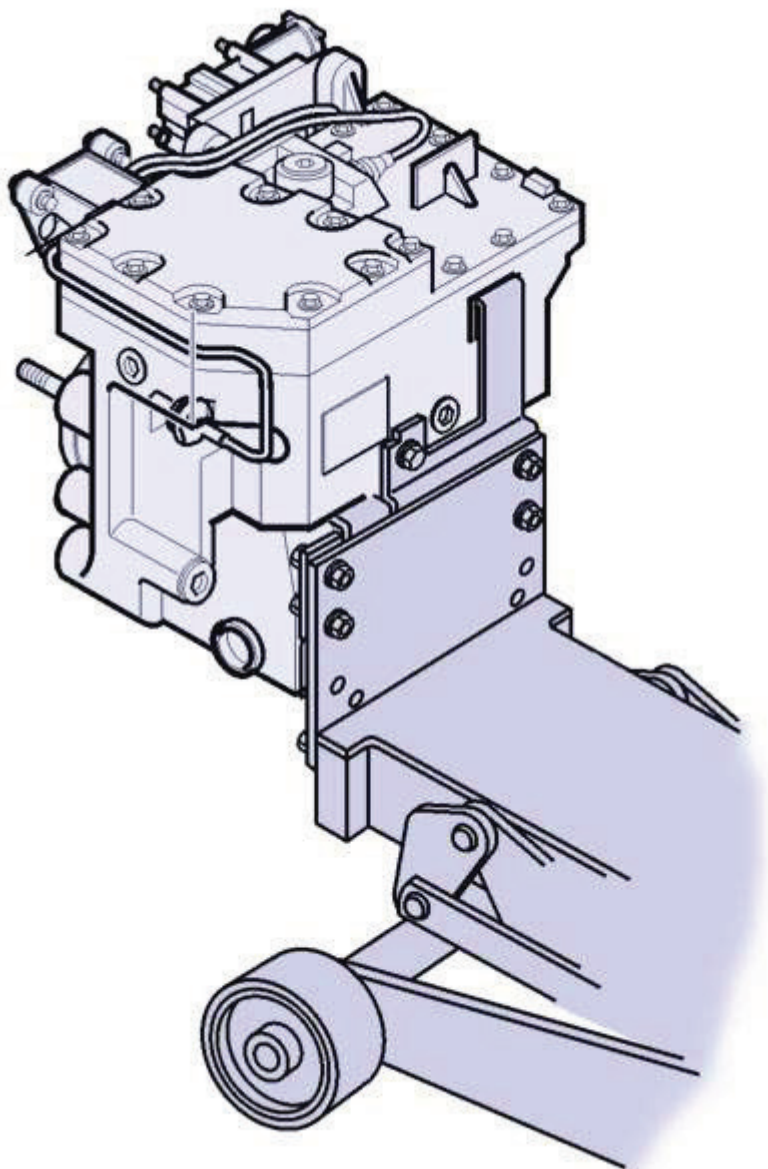

332 Instalar os anéis-O.



Nota

Usar peças novas.

333 Lubrificar os anéis-O.

Material necessário

Graxa

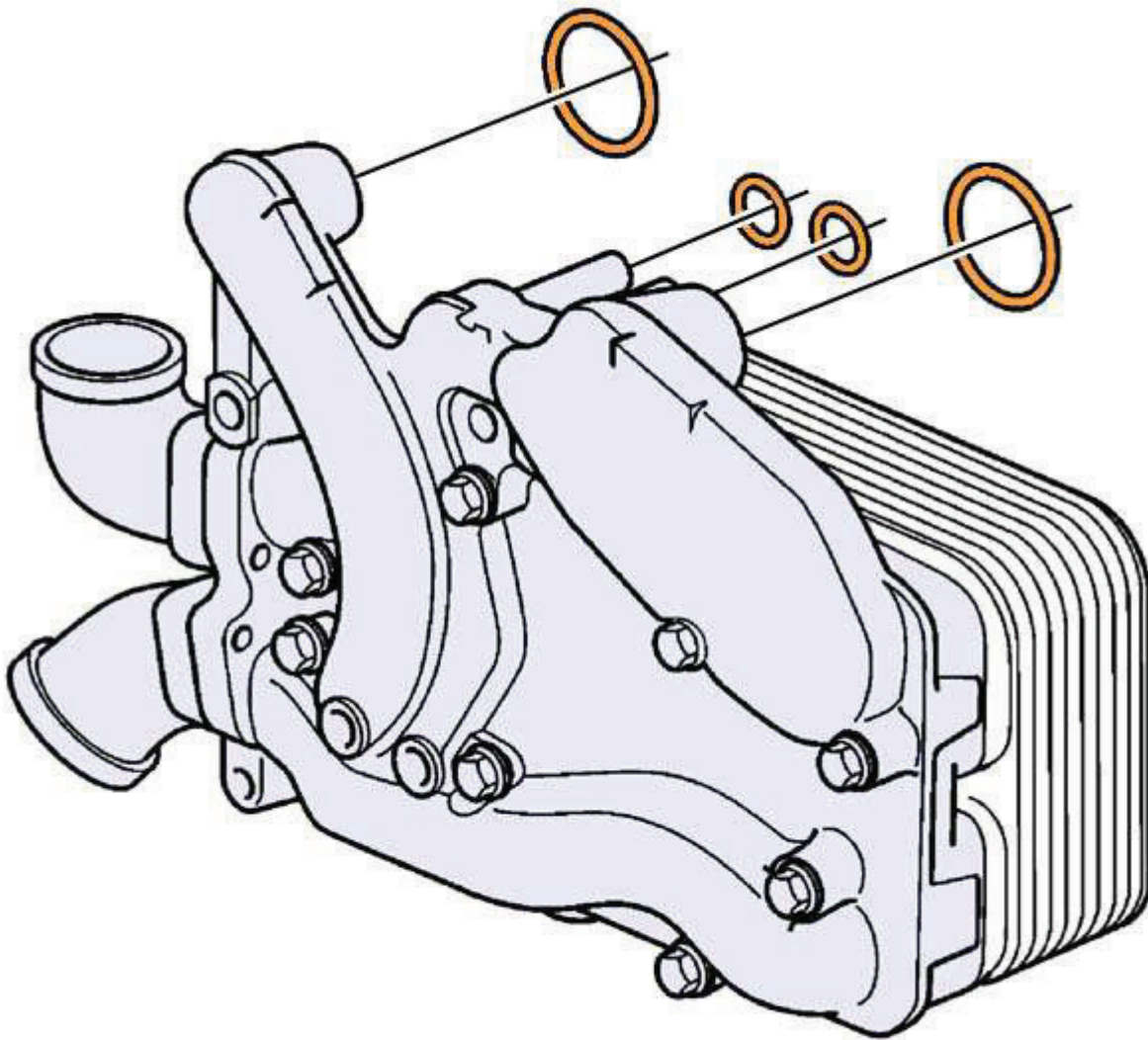

334	Instalar o trocador de calor.	
335	Instalar os parafusos.	
336	Apertar os parafusos com o torque adequado.	
	Torque	
	Trocador, retardador, parafuso	85 ±8,5 Nm

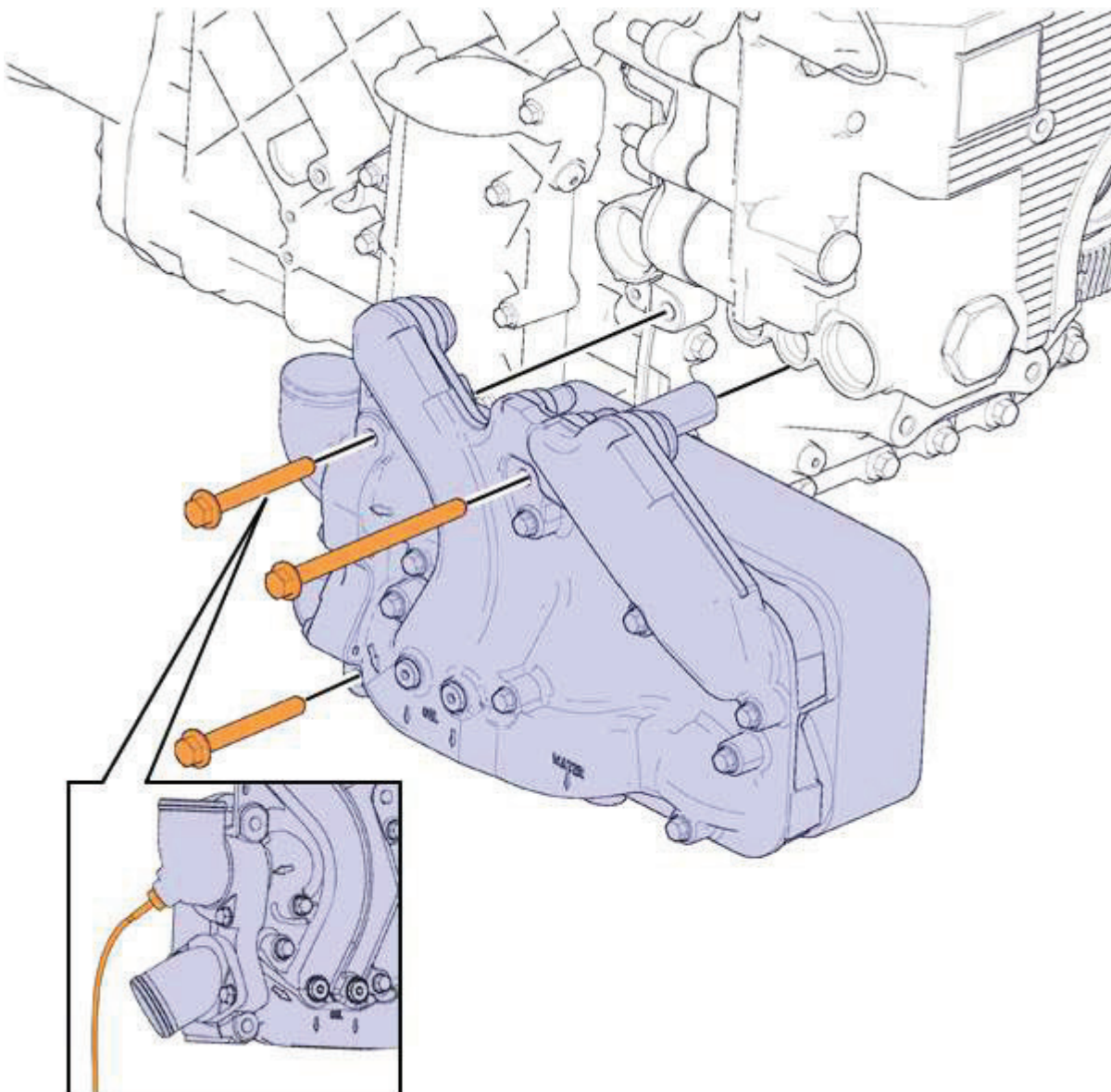

337 Posicione o chicote elétrico.

338 Instalar o parafuso (1).

339 Instalar a braçadeira de cabo.

i	Nota Use uma peça nova.
----------	-----------------------------------

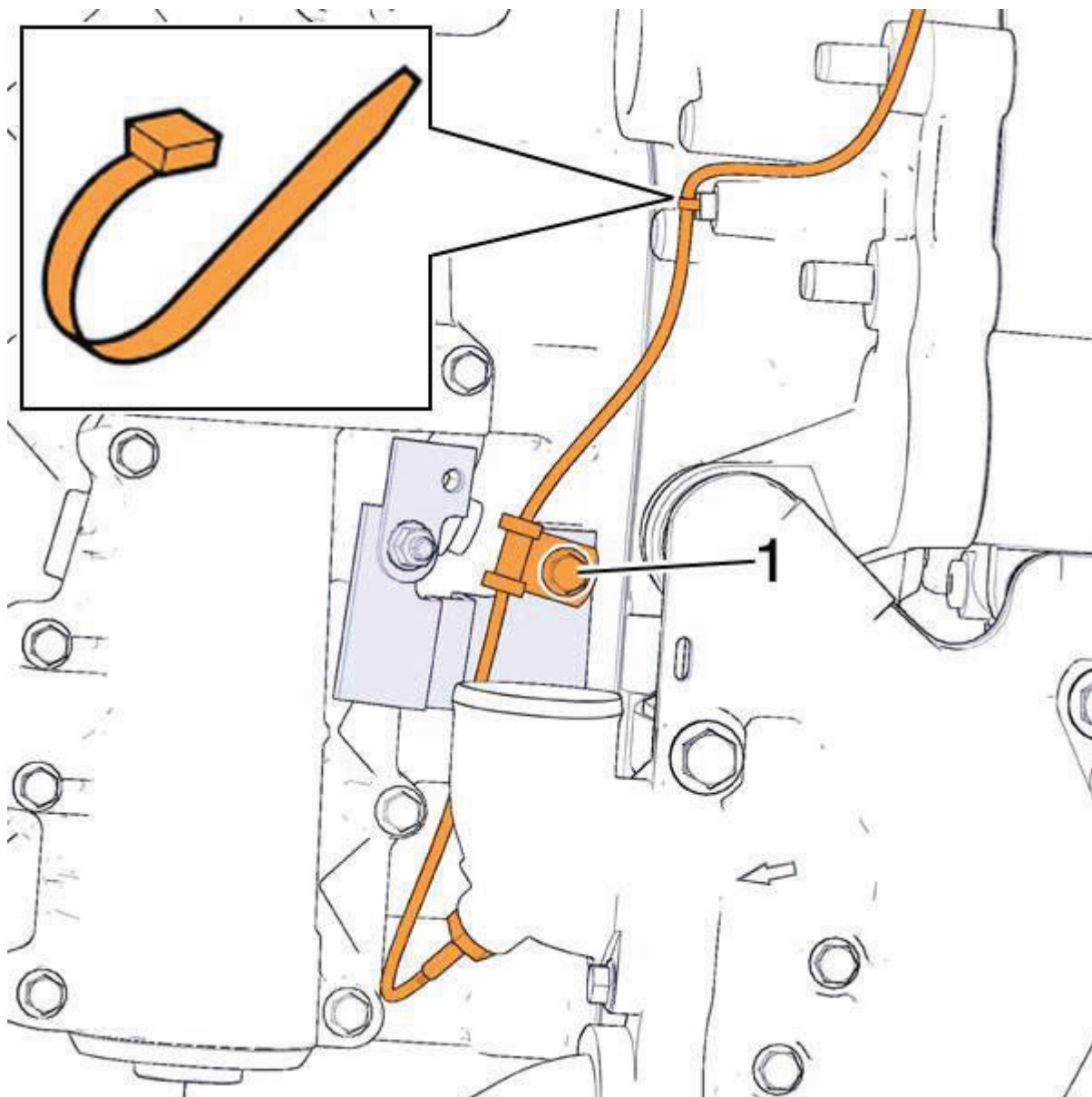

340	Posicionar o chicote (3).
-----	---------------------------

341	Instalar o parafuso (2).
-----	--------------------------

342	Conectar os conectores (1).
-----	-----------------------------

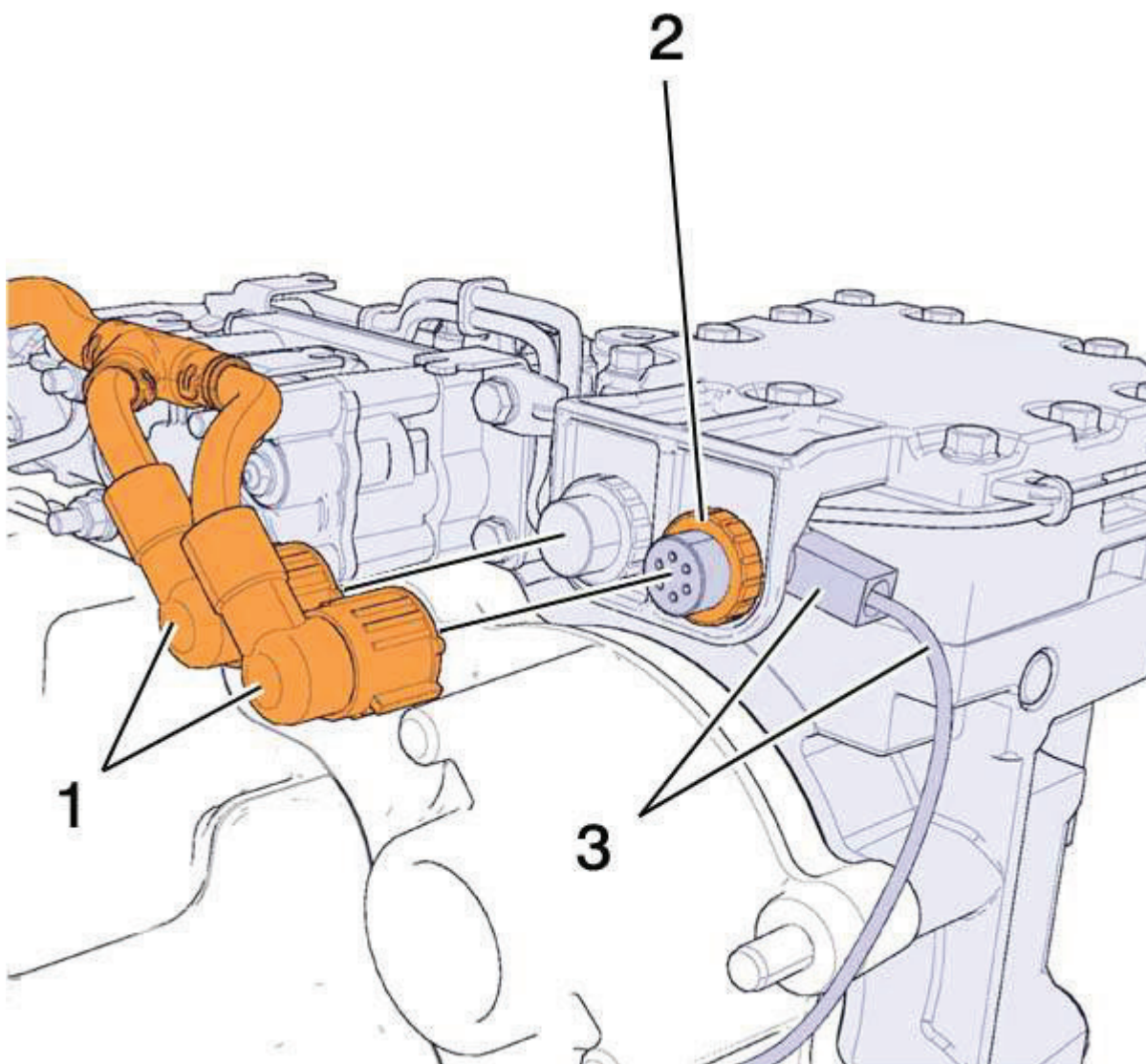

343 Instalar as braçadeiras de cabos.



Nota

Usar peças novas.

344 Instalar o tubo.

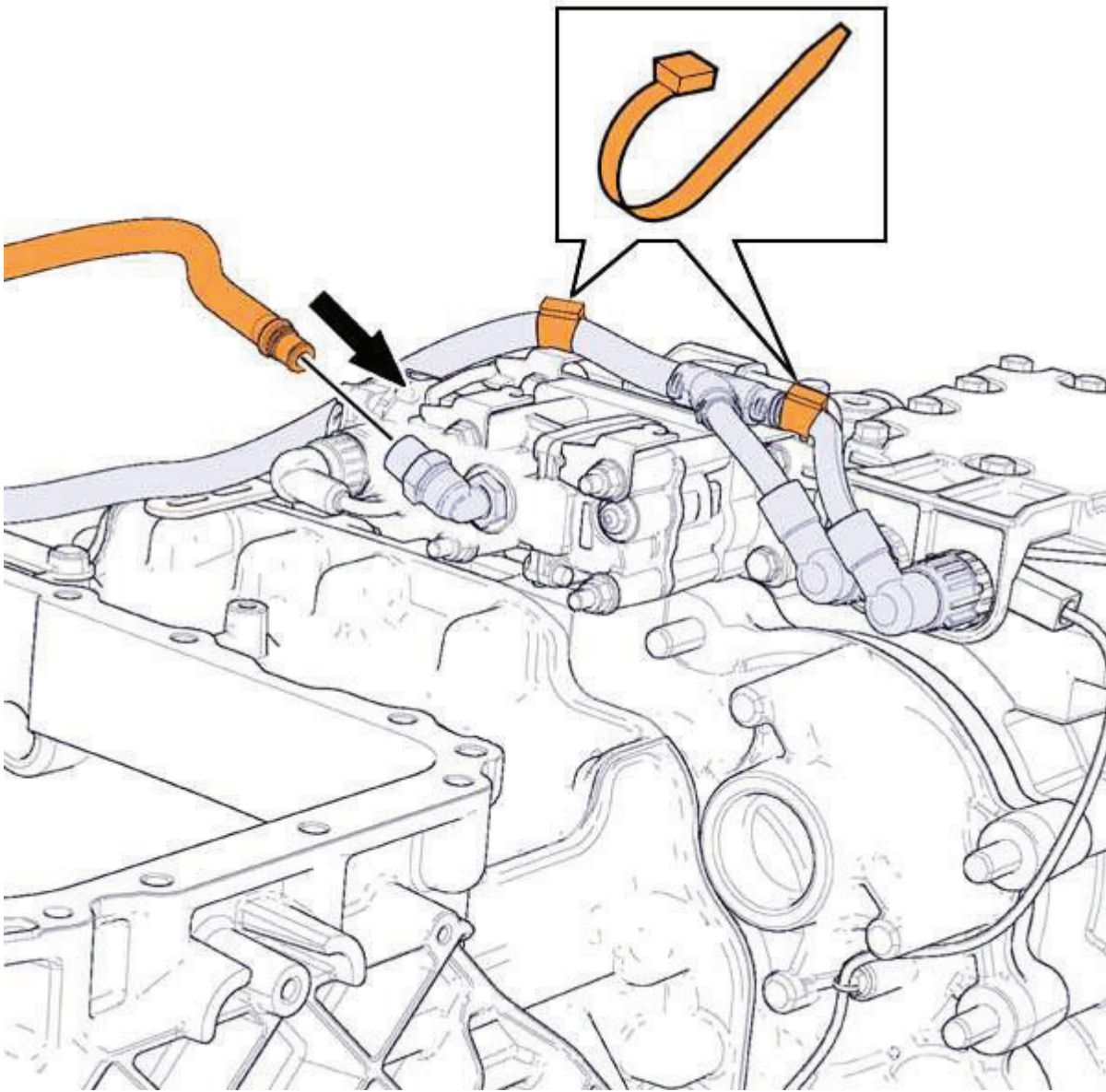

345 Instale a junta.

346 Instalar o conjunto do filtro de óleo.

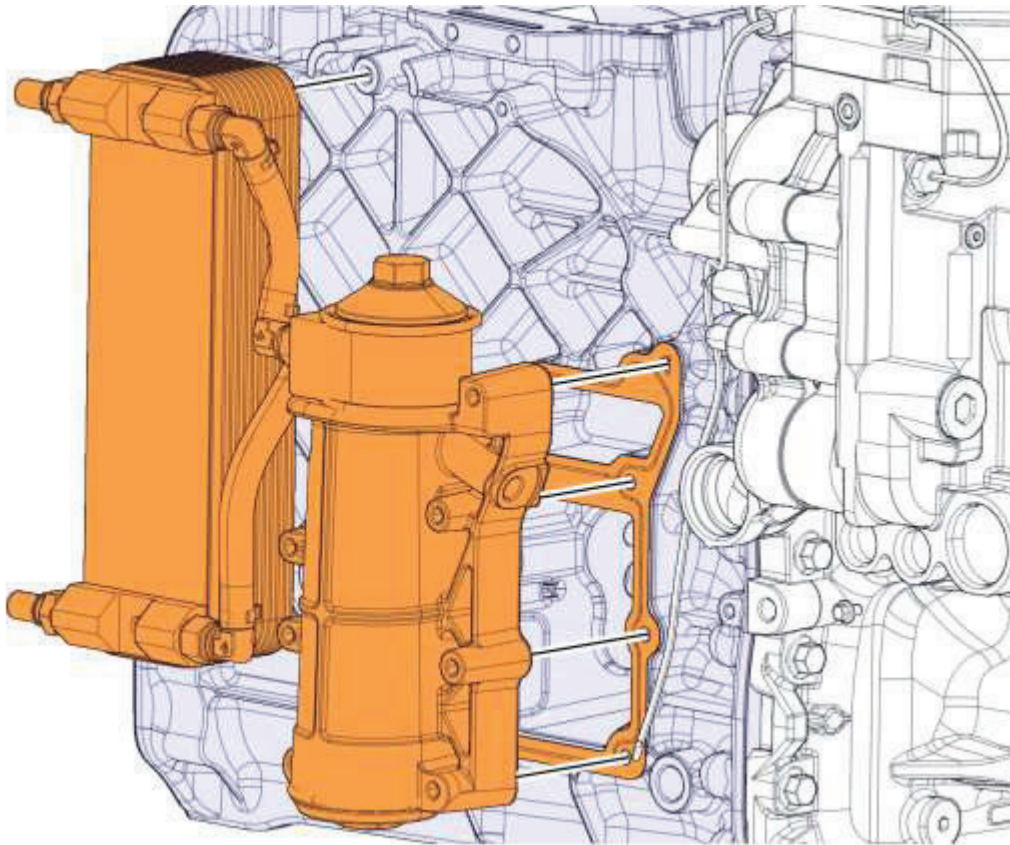

347 Instalar o suporte.

348 Instalar os parafusos.

Torque

Resfriador de óleo, parafuso	M10
	50 ±5 Nm